

WIRELESS AREA LIGHTING CONTROLLER

EN-ALC-ZB-BK

 Luminaire or
Junction Box Mount

 Wireless Range - 30 m (100 ft)
line of sight, 15.2 m (50 ft)
standard walls when mounted
outside of the junction box

Damp rated model available



On/Off switching

 Single 0-10V dimming
output, capable of sinking
30mA*

 *Maximum wire length:
30m (100ft.) Class 1;
76.2m (250 ft.) Class 2

DESCRIPTION

The Wireless Area Lighting Controller (WALC) is a wireless control device that operates a switched line AC and 0-10V control to luminaires. It communicates to the Wattstopper PLUS Wireless Manager over a wireless mesh network.

These individually addressable devices can switch an electrical load up to 20A or a wired zone of multiple luminaires ON or OFF via an integrated high-current relay while setting the zone's overall light level with a 0-10V dimming output wired to the luminaires' dimming ballasts or LED drivers. The WALC 0-10V dimming output is fully isolated and suitable for installation as either an NEC Class 2 or Class 1 wiring.

The WALC also includes a 3 wire terminal block to allow connection for an analog low voltage occupancy or daylight sensor.

FEATURES

- Control for 0-10V dimmable and fixed output ballasts/LED drivers
- Provides hard-wire power to wallstations and sensors to enable wireless system designs without batteries
- Streamlines deployment with capability of powering low-voltage sensors with a built-in terminal block
- Enables wireless control for loads up to 20A
- Configurable high-end and low-end trim
- Mounts to the exterior of a junction box through a standard-size knockout
- Damp rated model available to suit environments with moderate degree of moisture such as basements and garages

SPECIFICATIONS

- Voltage: 120-347V
- Maximum Load Ratings:
 - 20A @120-347 VAC, Electronic Ballast/Tungsten/Resistive/General Purpose
 - 1.5HP @120-277 VAC, Motor
- Wireless Range: 30 m (100 ft) line of sight, 15.2 m (50 ft) through standard walls
- Radio Frequency: 2.4GHz
- Operating Temperature:
 - -40° to 149°F (-40° to 65°C) @10A
 - -40° to 131°F (-40° to 55°C) @20A
- Weight: 178 g (60.3 oz)
- Relative Humidity: 0% to 95%, non-condensing
- Certifications:
 - UL916 (Energy Management Equipment)
 - UL924 cUL US Listed (Emergency Lighting Equipment)
 - UL2043 Plenum Rated
 - FCC Part 15/ICES-003
 - RoHS Compliant
- 5 year warranty

PROJECT		LOCATION/ TYPE	
---------	--	-------------------	--

DIMENSIONS

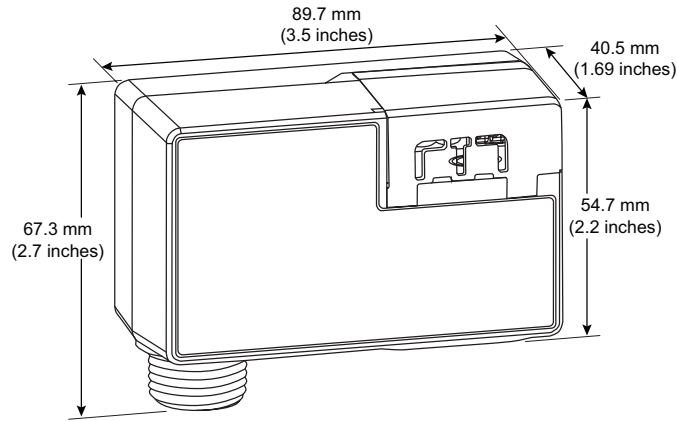

SYSTEM OVERVIEW

This illustration shows how each component is easily integrated into the Wattstopper PLUS System.

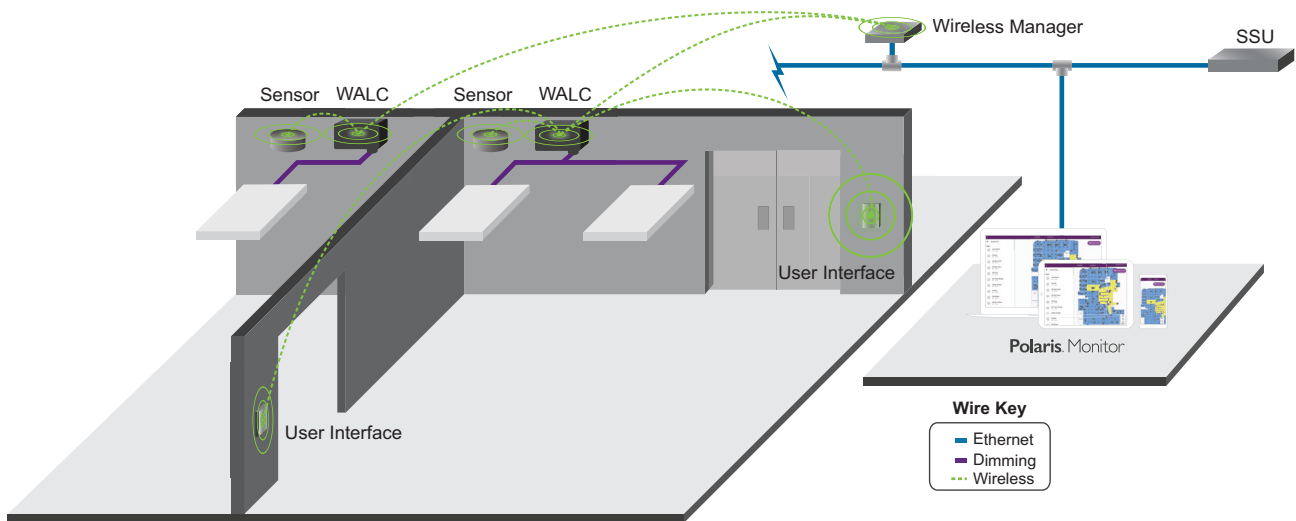

WIRING

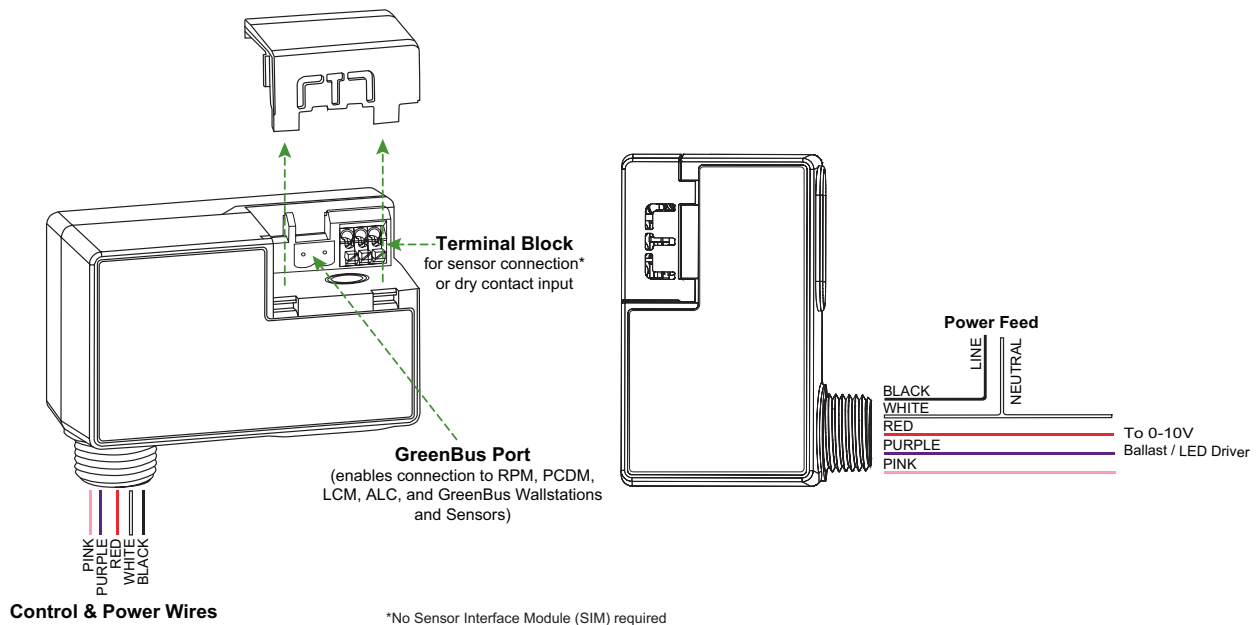

WALC to Dimming Ballast/LED Driver Wiring

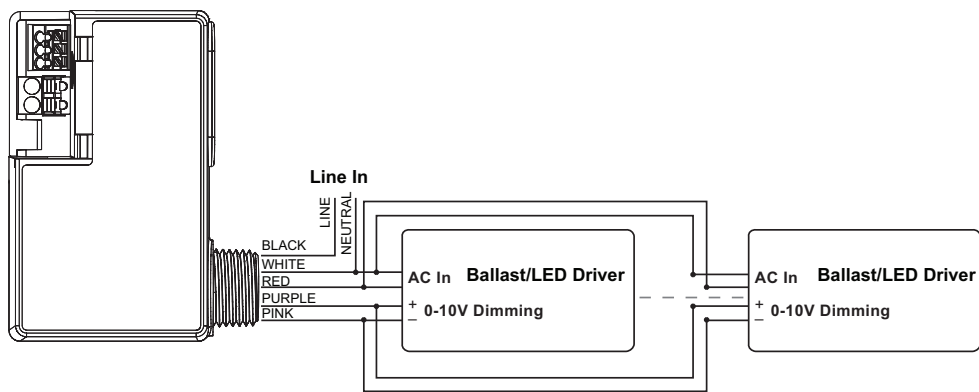

For a non-dimming fixture, cap off unused wire ends with UL Listed Wire Nut

WALC to Third Party Sensor Wiring

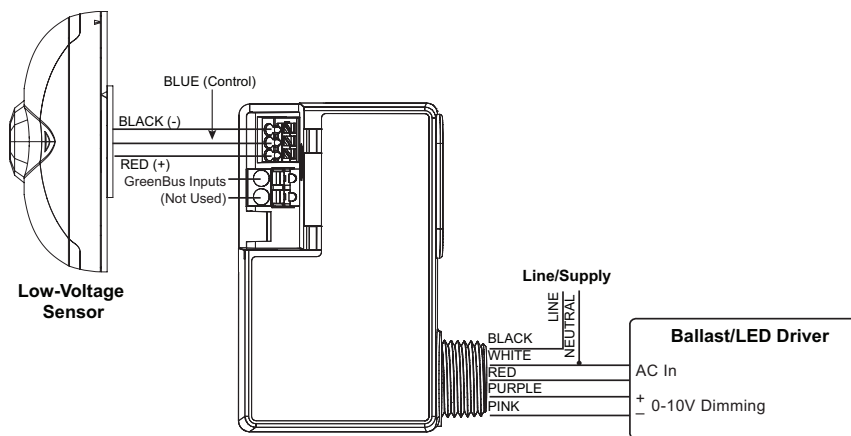

MOUNTING

The mechanical construction allows for simple installation of the module in an available PG-7 (0.5 inch) trade-size knockout on top or side of a luminaire. For some installations, a junction box may be required. In this situation, Wattstopper recommends securely mounting the WALC to the junction box using an available PG-7 (0.5 inch) trade-size knockout and retainer nut.

Luminaire Mount

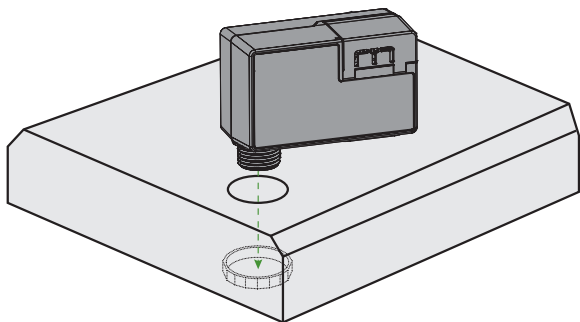

Junction Box Mount

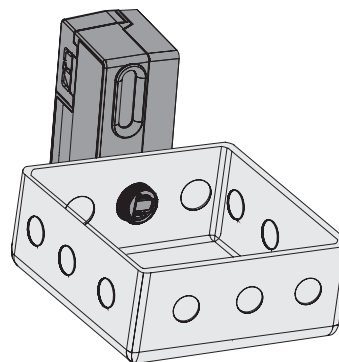

ORDERING INFORMATION

Catalog #	Description	Communication Network
■ EN-ALC-ZB-BK	Wireless Area Lighting Control Module	Wireless
■ EN-ALC-ZB-BK-DR	Wireless Area Lighting Control Module, damp rated	Wireless