

# Mini Bullet Flood Light Instruction



PLEASE READ THESE INSTRUCTIONS CAREFULLY AND SAVE THEM, YOU MAY NEED THEM AT A LATER DATE.

**Warning:** Failure to install and wire fixture in accordance with the national electrical codes (NEC), all applicable federal, state and local electrical codes, as well as specific U.L. Safety standards for the intended working environment (location/application), may cause serious personal injury, death and/or property damage. This product must be installed by a person familiar with the construction and operation of the product and the hazards involved.

**Caution:** Turn off power from the main circuit before installing fixture. Make sure fixture is grounded per national electrical codes (NEC).

**Important note:** The safeguards and instructions appearing on this page are not meant to cover all possible conditions and situations that may occur. It may be understood that common sense, cautions and care, are factors which cannot be built into any product. The person(s) installing, operating and responsible for the light fixture must execute these factors.

**Warning:** Risk of fire and electrical shock. Most dwellings built before 1985 have supply wires rated 60 degrees C. Consult a qualified electrician before installing. If supply wires are located within 3 inches of the ballast, use wires rated at least 90 .

**Caution:** To help prevent the possibility of electrical shock, the use of rubber sole shoes is recommended. Exercise care; use work gloves when handling the fixture to avoid cuts or abrasions.

## Operating Instructions

### **Wiring:**

Caution: Turn off electrical power at fuse or circuit breaker box before wiring fixture to the power supply

#### **Twist-on wire connector**

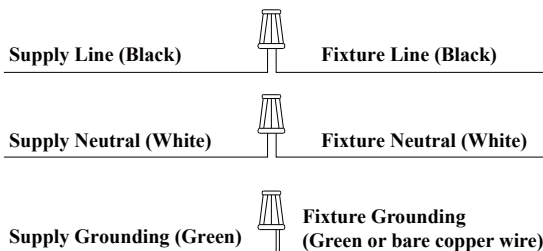

#### **Wiring layout without photocell**

### **Mounting Instructions :**

1. Remove fixture components and parts pack. Check that all parts are included.

Turn off power at circuit breaker box.

Caution: Do not rely on wall switch alone to turn off power.

2. Inspect components to ensure that male and female port threads and sealing surfaces are free of burrs, nicks and scratches or any foreign material.

3. Insert the 1/2" NPT threaded knuckle on the fixture into the 1/2" NPT threaded Junction box (not included), or a 1/2" NPT threaded mounting plate (not included), or a 1/2" NPT conduit (not included) as shown.

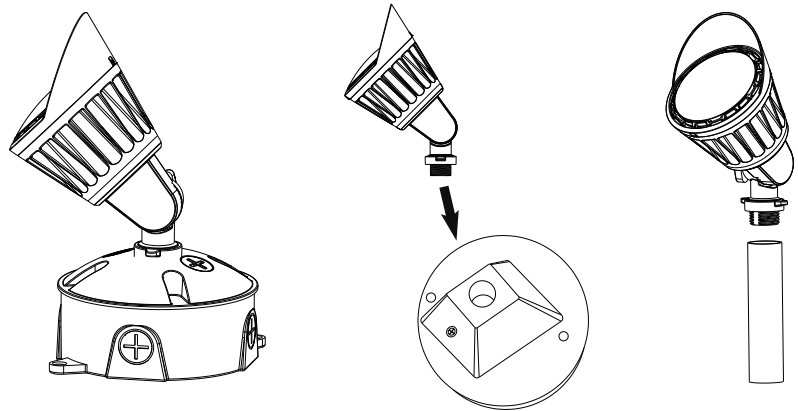

4. To adjust the aiming angle of the fixture, loosen the screw holding the knuckle mount together. Adjust the fixture to the desired angle, and re-tighten the screw.

5. Inspect to ensure that the washer is seated flat on the mounting surface.

6. Connect input power to the fixture, reference the wiring diagram above. Make sure that the power supply is disconnected at the circuit breaker before installing.

7. Turn on electricity at fuse or circuit breaker box to verify success of installation.