

NEW CONSTRUCTION SPECFIT INSTALLATION GUIDE - WARNING

WARNING – GREEN CREATIVE fixtures are designed to meet the latest NEC requirements. Check your local code requirements prior to installation.

WARNING – Fixture should be installed by a licensed electrician and must be installed in accordance with the NEC and all local building codes.

WARNING – Read all product labels and instructions before installing fixture.

WARNING – Wear safety gloves and other appropriate safety equipment.

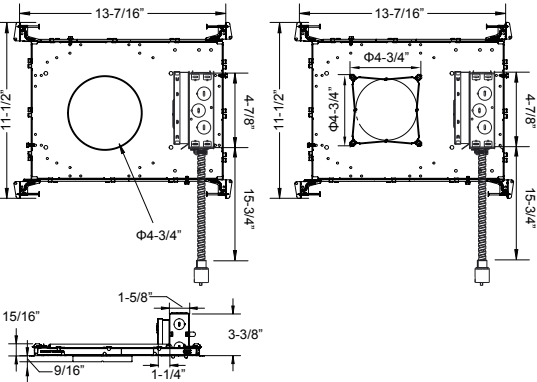
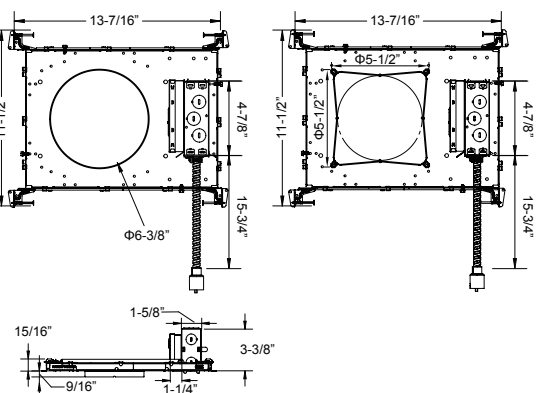
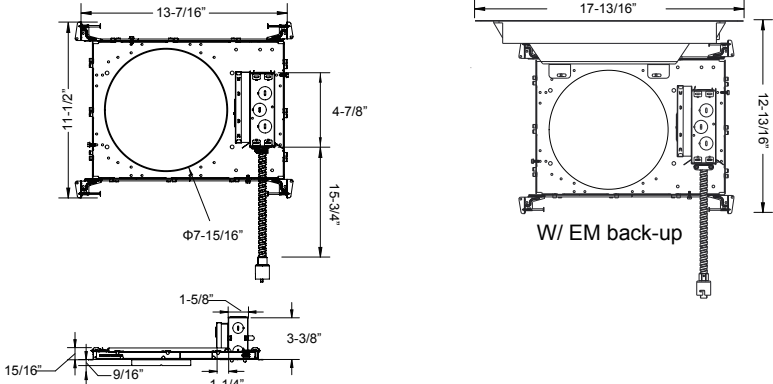
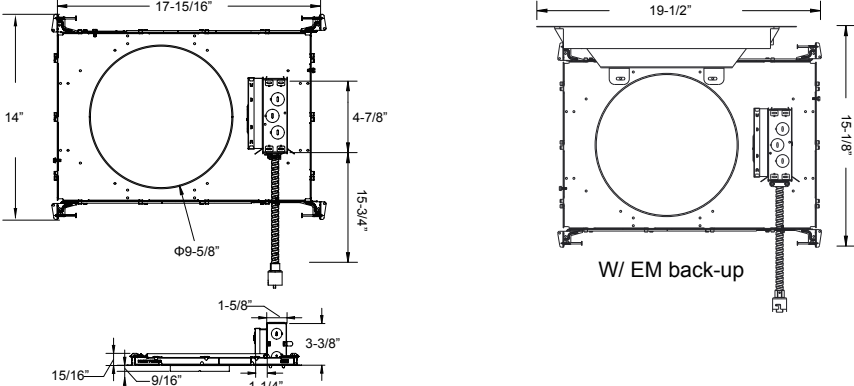
Product Information	Compatible Products
 <p>W/ EM back-up</p>	NC SPECFIT 4"
 <p>W/ EM back-up</p>	NC SPECFIT 6"
 <p>W/ EM back-up</p>	NC SPECFIT 8"
 <p>W/ EM back-up</p>	NC SPECFIT 9.5"

NEW CONSTRUCTION SPECFIT DRYWALL INSTALLATION

1. Make sure the POWER IS TURNED OFF at the source to the location in which you are installing the product.
2. Using a hammer, secure the bar hangers to the wood joist with the nail. Secure at all four locations (Fig. 1). For steel studs, use self-tapping sheet metal screws in place of nails.
3. Adjust and center the downlight opening hole as desired, by sliding the frame along the bar hangers. Lock and secure the frame with the bar hangers by tightening the edging screws. (Fig. 2)

Fig.1

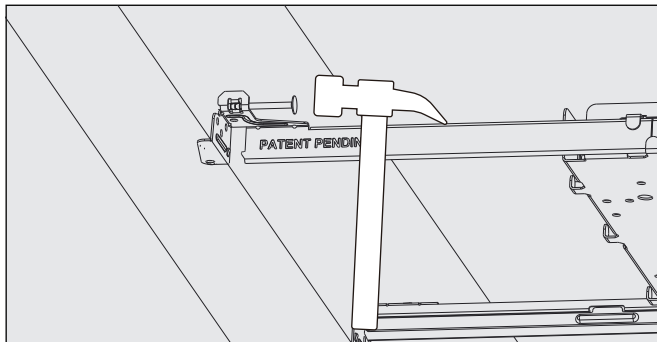
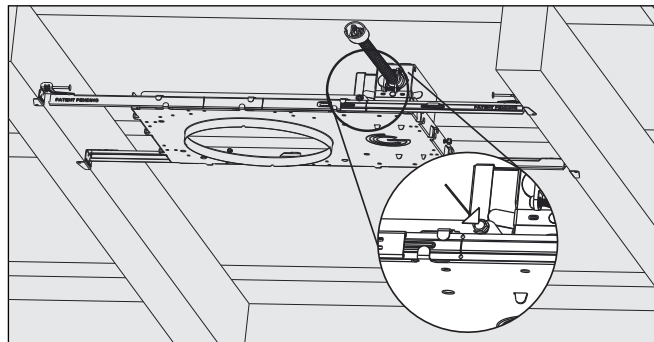

Fig.2



NEW CONSTRUCTION SPECFIT T-Grid INSTALLATION

4. Extend the bar hangers and secure to the ceiling T-Grid using the vertical slots at the end of each bar hanger.
5. Adjust and center the downlight opening hole as desired, by sliding the frame along the bar hangers. Lock and secure the frame with the bar hangers by tightening the edging screws. (Fig. 3)
6. If required by code, connect the bar hangers to the T-grid with self-tapping sheet metal screws. (Fig. 4)

Fig.3

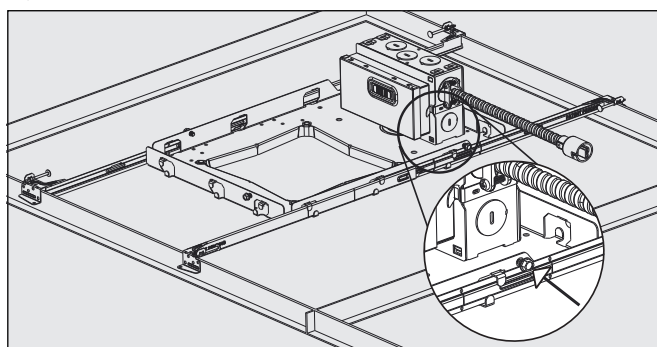
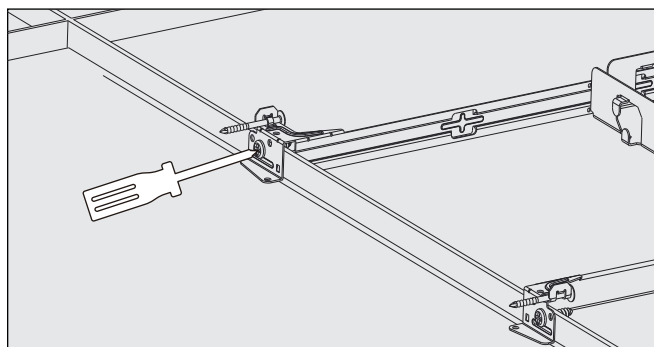

Fig.4



NEW CONSTRUCTION SPECFIT INSTALLATION

7. Once the Specfit New construction rough in frame is installed and secure. Open the driver face plate by gently pulling the metal tab. (fig. 5)
8. Insert the incoming power source MC cable directly to the junction box, through one of the knock-out, secure it. Connect power source wires to the driver (black to hot (L), white to neutral (N), green to ground), using the wire nuts. For dimming circuits, connect grey to - and purple to +, using the wire nuts. Close and reattach the Face plate. (Fig. 6)
9. If a new hole is needed, use a hole cutter to cut along the edge of the new construction round or square collar for the desired size (fig. 7)
10. Reach and make sure the driver Flex is accessible from the ceiling hole. (Fig. 8)

Fig.5

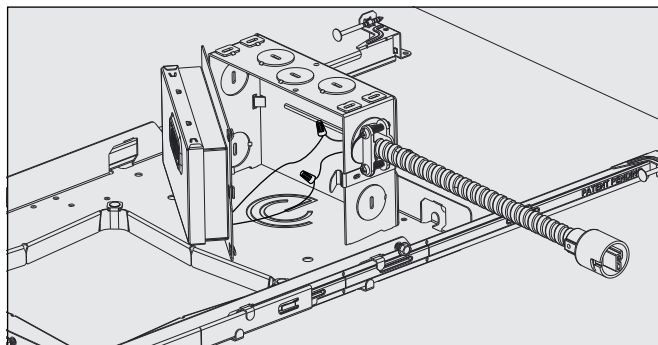

Fig.6

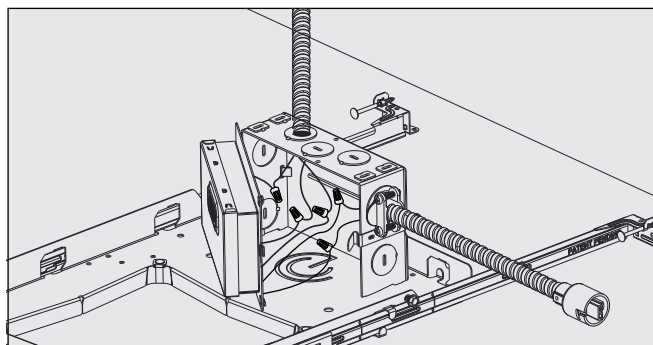

Fig.7

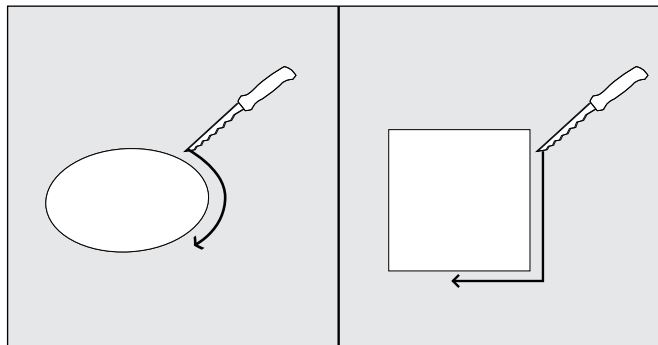
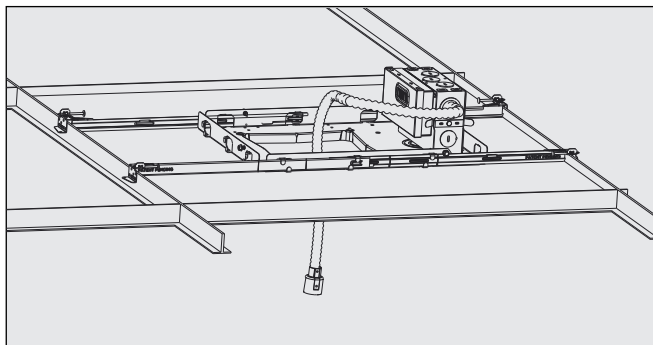

Fig.8



NEW CONSTRUCTION SPECFIT INSTALLATION

11. To change the lens, turn the existing lens counterclockwise until it comes out of the light engine. Place the feet of the new lens into the three slots and turn clockwise until firmly in place (fig. 9).
12. Attach the reflector to the light engine by inserting the cylindrical pins of the light engine into the L-shaped slots of the reflector. Turn counterclockwise to lock the reflector in place, as shown on the light engine markings (fig. 10).
13. Connect the driver box to the light engine using the attached quick connectors. Make sure the cable collars are secure by inserting the pin into the L-shaped slot and turning until firmly in place (fig. 11).

Fig.9

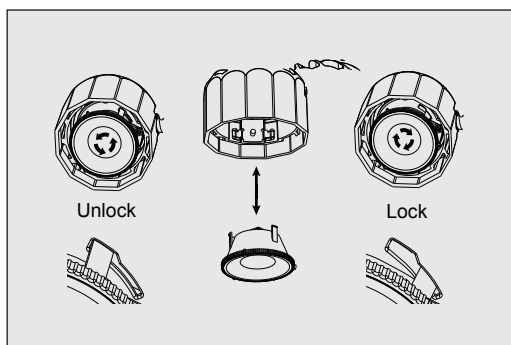

Fig.10

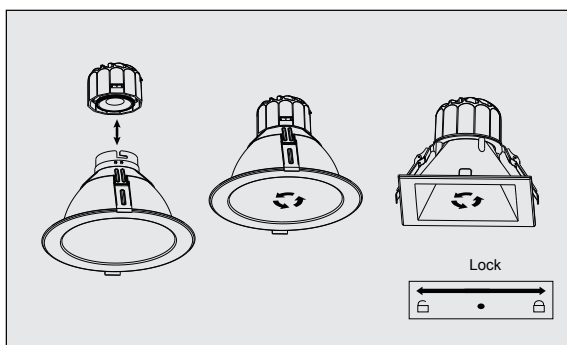
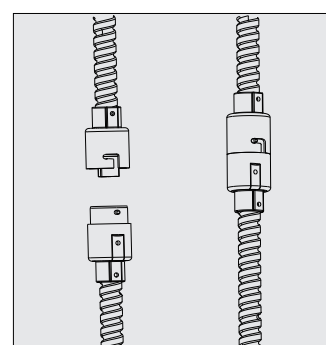

Fig.11



NEW CONSTRUCTION SPECFIT INSTALLATION

14. Squeeze the two reflector springs so they are in an upright position and insert lamp into the ceiling and rough in frame (fig. 12).
15. Once fixture is inside the ceiling, release the reflector clips and continue pushing lamp into the ceiling until securely fixed and flush with ceiling (fig. 13).
16. For square reflector make sure the reflectors tabs are well inserted inside the collars, so you can slightly adjust the position for perfect alignment. (Fig 14.)
17. Restore power at the source and the installation is complete

Fig.12

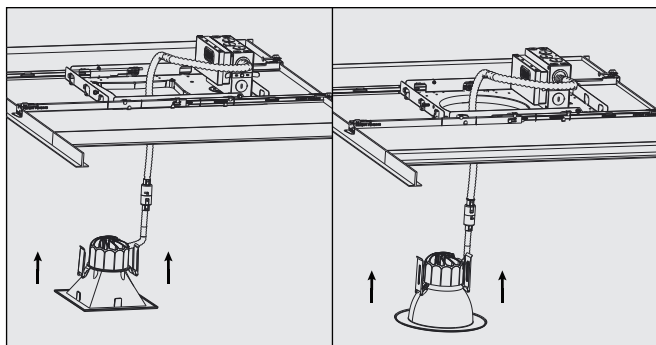

Fig.13

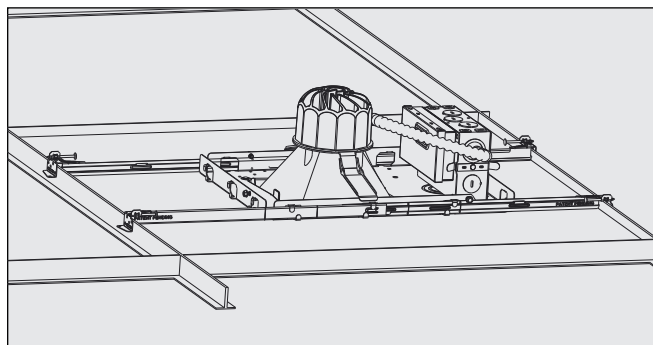

Fig.13

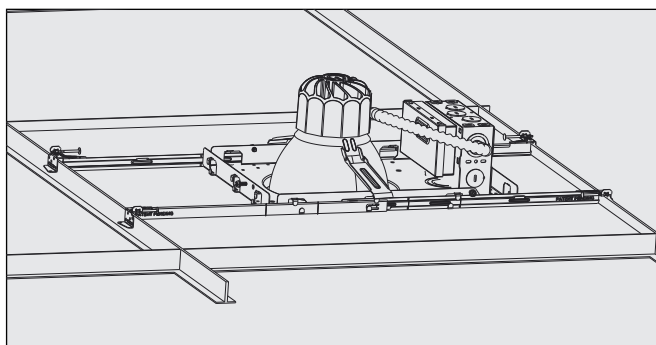
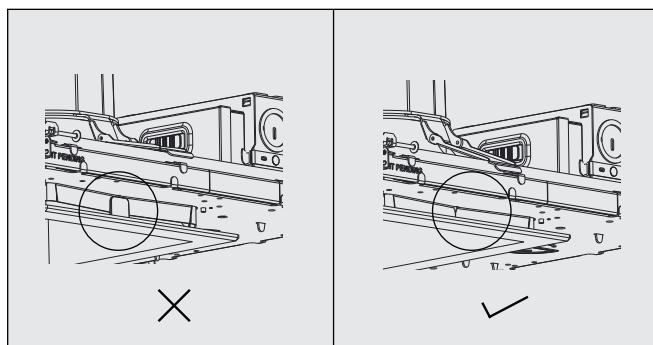

Fig.14



CEILING CUTOUT

	Minimum Cutout	Maximum Cutout
4" Round	$\Phi 4-7/8"$	$\Phi 5-5/8"$
4" Square	4-7/16" x 4-7/16"	5-3/16" x 5-3/16"
6" Round	$\Phi 6-1/2"$	$\Phi 7-1/4"$
6" Square	6-1/8" x 6-1/8"	6-7/8" x 6-7/8"
8" Round	$\Phi 8-1/16"$	$\Phi 8-13/16"$
9.5" Round	$\Phi 9-3/4"$	$\Phi 10-1/2"$