



LED COMMERCIAL DOWNLIGHT

► **DESIGN** - LED COMMERCIAL DOWNLIGHT are available in a durable aluminum housing that is resistant to rust and impacts. The lenses are anti-glare and spring-loaded clips are used to secure the fixture in place. The cord is metal and measures 1.6 feet in length. These downlights operate on 120-277V circuits and are compatible with a 0-10V dimming driver. Emergency models include a built-in battery backup that provides 90 minutes of continuous operation.

► **COLOR AND POWER SELECTABLE** - You can choose between 2,700K soft white, 3,000K warm white, 3,500K neutral white, and 4,000K cool white color temperatures, as well as 5,000K daylight color temperature, and adjust the power output from 12 watts to 40 watts (depending on the model) with a simple control switch.

► **CRI90+** - Rating provides rich and natural colors and keeps your space looking and feeling vibrant. True bright colors also improve your mood and general health.

► **INSTALLATION** - This fixture is IC rated so there is no can or any other housing required. It is also Wet Locations rated, making it perfect for any spaces with humidity requirements. Perfect for retail, hospitality, or any other commercial space with a high ceiling.

► **ADVANTAGES** - These fixtures have a long lifespan of 50,000 hours and are designed to last for decades under normal use. ASD provides a 5-year limited warranty, along with ETL and Energy Star certifications, to ensure the highest quality products and safety.

Catalog number	
Notes	
Type	



Model	Size	Watts	Voltage	Dimmable	Lumens	CCT	Finish	Dimensions (DxH)	Cord	Pre-installed
CDL7R ROUND										
ASD-CDL7R-6A30WH	6 inch	12/16/22/26/30W	120-277 V	0-10 V	up to 3,352 lm	5CCT (2,700/3,000/3,500/4,000/5,000 K)	White	8-3/8" x 4-13/16"	1.5 ft	-
ASD-CDL7R-8A35WH	8 inch	16/22/26/30/35W	120-277 V	0-10 V	up to 4,245 lm	5CCT (2,700/3,000/3,500/4,000/5,000 K)	White	10-5/16" x 5-5/16"	1.5 ft	-
ASD-CDL7R-10A40WH	10 inch	22/26/30/35/40W	120-277 V	0-10 V	up to 4,791 lm	5CCT (2,700/3,000/3,500/4,000/5,000 K)	White	11-9/16" x 5-15/16"	1.5 ft	-
CDL7S SQUARE										
ASD-CDL7S-6A30WH	6 inch	12/16/22/26/30W	120-277 V	0-10 V	up to 3,009 lm	5CCT (2,700/3,000/3,500/4,000/5,000 K)	White	8-11/16" x 8-11/16" x 4-5/16"	2.3 ft	-
ASD-CDL7S-8A35WH	8 inch	16/22/26/30/35W	120-277 V	0-10 V	up to 3,711 lm	5CCT (2,700/3,000/3,500/4,000/5,000 K)	White	10-1/4" x 10-1/4" x 4-1/4"	2.3 ft	-
CDL7R ROUND WITH BATTERY BACK-UP										
ASD-CDL7R-6A30WH-EM	6 inch	12/16/22/26/30W	120-277 V	0-10 V	up to 3,352 lm	5CCT (2,700/3,000/3,500/4,000/5,000 K)	White	8-11/16" x 4-5/16"	2.3 ft	15W Battery back-up
ASD-CDL7R-8A35WH-EM	8 inch	16/22/26/30/35W	120-277 V	0-10 V	up to 4,245 lm	5CCT (2,700/3,000/3,500/4,000/5,000 K)	White	10-1/4" x 4-5/16"	2.3 ft	15W Battery back-up

For detailed luminous flux information please refer to Annex 1, page 6.

For most up-to-date spec sheets please refer to asd-lighting.com

ASD LIGHTING CORP

E-mail: orders@asd-lighting.com | Web site: www.asd-lighting.com





LED COMMERCIAL DOWNLIGHT

PRODUCT SPECIFICATIONS:

Construction & Materials						
Housing	Aluminum					
Lens	PC					
Finish	White					
Weight	ASD-CDL7R-6A30WH	1.2 lbs (0.5 kg)	ASD-CDL7S-6A30WH	1.9 lbs (0.9 kg)	ASD-CDL7R-6A30WH-EM	3.4 lbs (1.6 kg)
	ASD-CDL7R-8A35WH	1.5 lbs (0.7 kg)	ASD-CDL7S-8A35WH	2.6 lbs (1.2 kg)	ASD-CDL7R-8A35WH-EM	3.8 lbs (1.7 kg)
	ASD-CDL7R-10A40WH	1.8 lbs (0.8 kg)				
Environmental system						
Work environment	Suitable for Wet Locations					
Operating temperature	-4°F to 104°F (-20°C to 40°C)					
L-70 Life	> 50,000 hrs					
Optical system						
Color temperature	5CCT switch (2,700/3,000/3,500/4,000/5,000 K), 5,000 K by default					
CRI	> 90					
Electrical system						
Input voltage	120-277 V					
Max input current	ASD-CDL7R-6A30WH	0.25 A	ASD-CDL7S-6A30WH	0.25 A	ASD-CDL7R-6A30WH-EM	0.25 A
	ASD-CDL7R-8A35WH	0.29 A	ASD-CDL7S-8A35WH	0.29 A	ASD-CDL7R-8A35WH-EM	0.29 A
	ASD-CDL7R-10A40WH	0.33 A				
Inrush current (Action time)	50 A (16 S)					
Off state power	0W					
Power consumption	ASD-CDL7R-6A30WH	12/16/22/26/30W	ASD-CDL7S-6A30WH	12/16/22/26/30W	ASD-CDL7R-6A30WH-EM	12/16/22/26/30W
	ASD-CDL7R-8A35WH	16/22/26/30/35W	ASD-CDL7S-8A35WH	16/22/26/30/35W	ASD-CDL7R-8A35WH-EM	16/22/26/30/35W
	ASD-CDL7R-10A40WH	22/26/30/35/40W				
Power factor	> 0.9					
Output voltage	75 A					
Max output current	ASD-CDL7R-6A30WH	0.37 A	ASD-CDL7S-6A30WH	0.37 A	ASD-CDL7R-6A30WH-EM	0.37 A
	ASD-CDL7R-8A35WH	0.45 A	ASD-CDL7S-8A35WH	0.45 A	ASD-CDL7R-8A35WH-EM	0.45 A
	ASD-CDL7R-10A40WH	0.52 A				
Surge protection DM/CM	2 kV / 2.5 kV					
Dimming compatible controls			Regular and voluntary certifications			
Brand	Lutron	Leviton	5-year limited warranty			
Models	MS-Z101	IP710-LFZ	cETLus certified 5005153			

PACKAGE CONTENTS:

Description	Quantity
LED Commercial Downlight	1
Wire nut (A)	3
Template for 6, 8 or 10 inch round or square (B)	1
Box	1

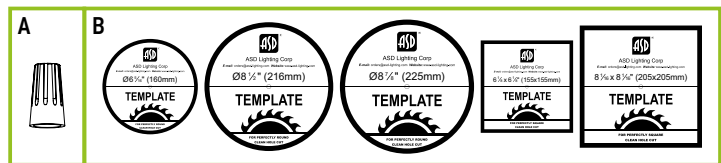

For most up-to-date spec sheets please refer to asd-lighting.com

ASD LIGHTING CORP

E-mail: orders@asd-lighting.com | Web site: www.asd-lighting.com





LED COMMERCIAL DOWNLIGHT

ACCESSORIES (sold separately):

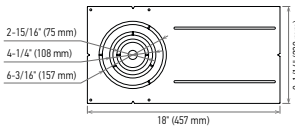
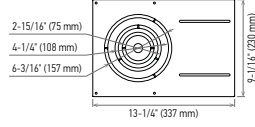
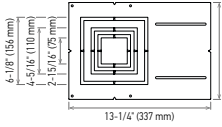
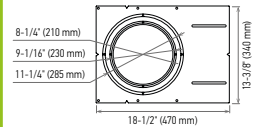
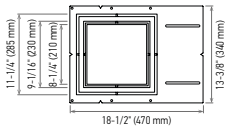
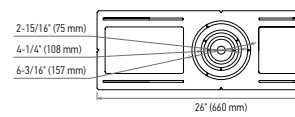
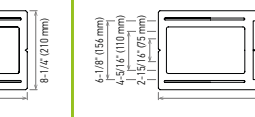
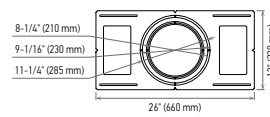
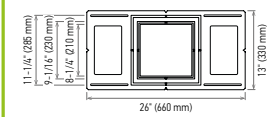
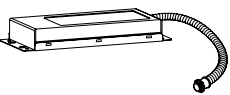
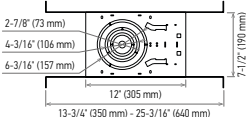
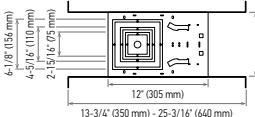
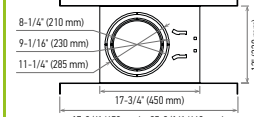
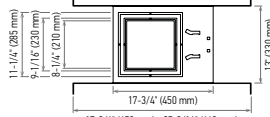
New construction flat mounting plate with asymmetric round holes 18" ASD-MPLR18-346-FA-6PACK 	New construction flat mounting plate with asymmetric round holes 3-4-6" ASD-MPLR-346-FA-6PACK 	New construction flat mounting plate with asymmetric square holes 3-4-6" ASD-MPLS-346-FA-6PACK 	New construction flat mounting plate with asymmetric round holes 8-10-12" ASD-MPLR-81012-FA-6PACK 	New construction flat mounting plate with asymmetric square holes 8-10-12" ASD-MPLS-81012-FA-6PACK 
New construction flat mounting plate with symmetric round holes 3-4-6" ASD-MPLR-346-FS-6PACK 	New construction flat mounting plate with symmetric square holes 3-4-6" ASD-MPLS-346-FS-6PACK 	New construction flat mounting plate with symmetric round holes 8-10-12" ASD-MPLR-81012-FS-6PACK 	New construction flat mounting plate with symmetric square holes 8-10-12" ASD-MPLS-81012-FS-6PACK 	
Battery back-up kit  8W BLD-HM08D 15W BLD-HM15D	New construction mounting plate with round holes and sliding clips 3-4-6" ASD-MPLR-346-SC-6PACK 	New construction mounting plate with square holes and sliding clips 3-4-6" ASD-MPLS-346-SC-6PACK 	New construction mounting plate with round holes and sliding clips 8-10-12" ASD-MPLR-81012-SC-6PACK 	New construction mounting plate with square holes and sliding clips 8-10-12" ASD-MPLS-81012-SC-6PACK 

ACCESSORY COMPATIBILITY LIST:

Accessories		Models													
		Battery back-up kit 8W BLD-HM08D	Battery back-up kit 15W BLD-HM15D	New construction flat mounting plate with asymmetric round holes 3-4-6" ASD-MPLR-346-FA-6PACK	New construction flat mounting plate 18" with asymmetric round holes 3-4-6" ASD-MPLR18-346-FA-6PACK	New construction flat mounting plate with asymmetric square holes 3-4-6" ASD-MPLS-346-FA-6PACK	New construction flat mounting plate with square holes and sliding clips 3-4-6" ASD-MPLS-346-FS-6PACK	New construction flat mounting plate with asymmetric round holes 8-10-12" ASD-MPLR-81012-FA-6PACK	New construction flat mounting plate with asymmetric square holes 8-10-12" ASD-MPLS-81012-FA-6PACK	New construction flat mounting plate with symmetric round holes 3-4-6" ASD-MPLR-346-FS-6PACK	New construction flat mounting plate with symmetric square holes 3-4-6" ASD-MPLS-346-FS-6PACK	New construction flat mounting plate with symmetric round holes 8-10-12" ASD-MPLR-81012-FS-6PACK	New construction flat mounting plate with symmetric square holes 8-10-12" ASD-MPLS-81012-FS-6PACK	New construction mounting plate with round holes and sliding clips 3-4-6" ASD-MPLR-346-SC-6PACK	New construction mounting plate with square holes and sliding clips 3-4-6" ASD-MPLS-346-SC-6PACK
ASD-CDL7R	6"	•	•	•	•					•				•	
	8"	•	•	•			•					•			•
	10"	•	•												
ASD-CDL7S	6"	•	•			•				•					
	8"	•	•					•				•			
ASD-CDL7R-EM	6"			•	•					•				•	
	8"						•					•			•

For most up-to-date spec sheets please refer to asd-lighting.com

ASD LIGHTING CORP

E-mail: orders@asd-lighting.com | Web site: www.asd-lighting.com





LED COMMERCIAL DOWNLIGHT

BUILT-IN BACK-UP BATTERY INFORMATION

Model	Battery watts	Lumens in emergency mode	Battery capacity	Emergency mode	Charging time
ASD-CDL7R-6A30WH-EM	15W	1,719 lm	2600 mAh * 4	> 90 min	≥ 24 hours
ASD-CDL7R-8A35WH-EM	15W	1,756 lm	2600 mAh * 4	> 90 min	≥ 24 hours

- ▶ Has a self-checking function.
- ▶ AC operation, indicator light will stay on.
- ▶ Emergency operation, indicator light will flash slowly (light on for 2 seconds, lightoff for 2 seconds).
- ▶ In a failure, indicator light will flash quickly (light on for 0.2 seconds, light off for 0.2 seconds).
- ▶ In order to test the Battery back-up, press test switch one time to switch to emergency mode. Press one more time to get back to AC mode.

STANDARD OPERATION DISPLAY STATUS:

Operating condition	ON
Charging	ON
Emergency mode	Flash slowly
Test failure	Flash quickly

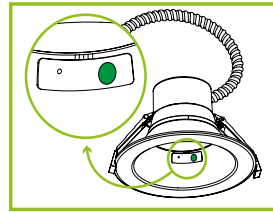

BATTERY BACK-UP KIT INFORMATION

BLD-HM08D **BLD-HM15D** sold separately:

Specifications	model: BLD-HM08D	model: BLD-HM15D
Input voltage	120-347 Vac, 50/60 Hz	
Input current	≤ 100 mA	
Output voltage	≤ 170 Vdc	≤ 175 Vdc
Output power	8W	15W
Lumen	800 lm	1,000 lm
Application	< 60W (0-10 V dimmable fixture)	< 100W (0/1-10 V dimmable fixture)
Ambient temperature	32°F to 122°F (0°C to 50°C)	

INSTALLATION GUIDE

IMPORTANT SAFETY INFORMATION:

Please read all the instructions below before installation.

- ▶ Make sure that the supply voltage corresponds to the rated product voltage.
- ▶ The product must be installed by a qualified electrician in accordance with the National Electrical Code and corresponding local codes.
- ▶ If the product is damaged, do not use it.

⚠ WARNING

Risk of personal injury – read and follow all warnings and installation instructions. Keep or give to the owner for future reference.

Risk of cuts: Wear gloves to prevent cuts or abrasions when removing from carton, handling, installing, and maintaining this product.

Risk of electric shock: This product must be installed in accordance with the applicable installation code by a person familiar with the construction and operation of the product and the hazards involved.

Risk of Fire: Minimum 194°F supply conductors. Consult a qualified electrician to ensure correct branch circuit conductor.

ASD® assumes no responsibility for claims arising out of improper or careless Installation or handling of this product.

ELECTRICAL SCHEMATIC DIAGRAM:

CDL7

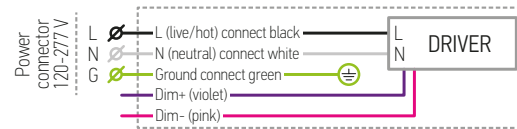

CDL7R-EM with battery back-up

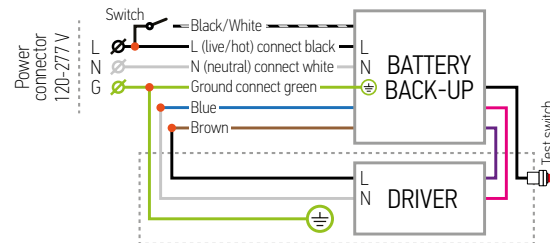

CDL7 with battery back-up kit

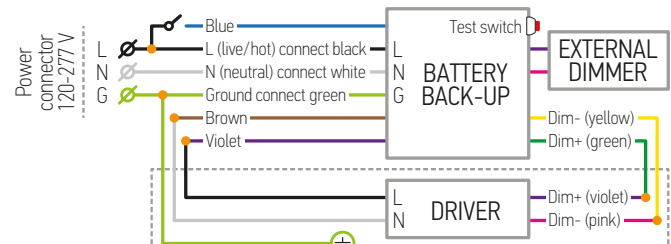

For most up-to-date spec sheets please refer to asd-lighting.com



LED COMMERCIAL DOWNLIGHT

INSTALLATION STEPS:

1. Use template to cut an appropriate sized hole. Before inserting the fixture into the mounting surface opening, choose power and color temperature with a simple switch.
2. Connect the wires using wire nuts: Black to Black, White to White, Green to Green.
3. Fold up the two spring mounting tabs and release as the fixture is placed into the mounting surface. Ensure that the spring mounting tabs have securely mounted the fixture so that the front trim is flush against the mounting surface.

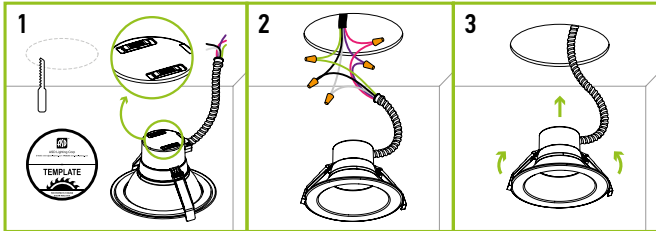

BATTERY BACK-UP KIT INSTALLATION

BLD-HM08D **BLD-HM15D** sold separately:

1. Secure the battery back-up to the ceiling.
2. Connect wires as shown on electrical diagram.
3. Connect test switch and affix it in the hole on surface.

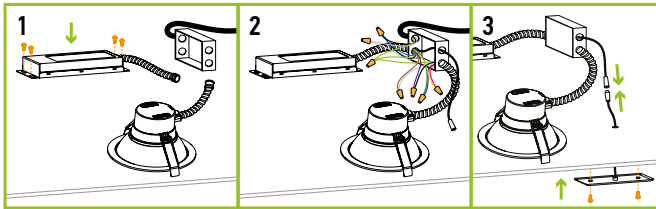

MOUNTING PLATE INSTALLATION

ASD-MPLR-346-FA	ASD-MPLS-346-SC	ASD-MPLR-81012-FS
ASD-MPLS-346-FA	ASD-MPLR18-346-FA	ASD-MPLS-81012-FS
ASD-MPLR-346-FS	ASD-MPLR-81012-FA	ASD-MPLR-81012-SC
ASD-MPLS-346-FS	ASD-MPLS-81012-FA	ASD-MPLS-81012-SC
ASD-MPLR-346-SC	sold separately:	

1. Remove the metal ring from the mounting plate according to the size of fixture.
2. Place the mounting plate and secure its position with screws on the beams.

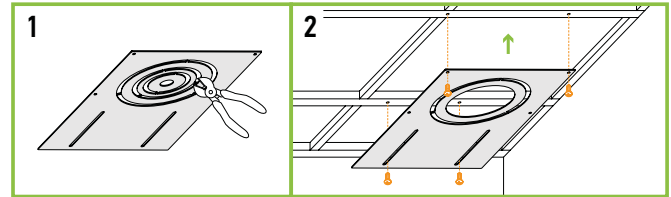

ORDERING INFORMATION

Model	UPC	Pcs. per carton	Carton size	Carton weight	GTIN 14
CDL7R ROUND 120lm/W					
ASD-CDL7R-6A30WH	810128113359	8	18.9" x 18.5" x 12.2"	14.4 lbs	10810128113356
ASD-CDL7R-8A35WH	810128113366	4	22.8" x 11.8" x 13"	9.9 lbs	10810128113363
ASD-CDL7R-10A40WH	810128113373	4	25.6" x 13.2" x 14.2"	12.3 lbs	10810128113370
CDL7S SQUARE					
ASD-CDL7S-6A30WH	810128114981	8	22.1" x 22.1" x 12.8"	23.6 lbs	10810128114988
ASD-CDL7S-8A35WH	810128114998	4	25.2" x 25.2" x 6.7"	16.4 lbs	10810128114995
CDL7R ROUND WITH BATTERY BACK-UP					
ASD-CDL7R-6A30WH-EM	810128114394	8	23.2" x 16.3" x 26"	36.5 lbs	10810128114391
ASD-CDL7R-8A35WH-EM	810128114400	4	25.2" x 16.3" x 13.9"	22.4 lbs	10810128114407

For most up-to-date spec sheets please refer to asd-lighting.com

ASD LIGHTING CORP

E-mail: orders@asd-lighting.com | Web site: www.asd-lighting.com





LED COMMERCIAL DOWNLIGHT

ACCESSORIES:

Model	Description	UPC	Pcs. (pack) per carton	Carton size	Carton weight	GTIN 14 in carton
BLD-HM08D	Battery back-up kit 8W	810128111508	10	17.1" x 14.6" x 11"	19.6 lbs	10810128111505
BLD-HM15D	Battery back-up kit 15W	810050734882	10	17.8" x 13.5" x 9.5"	25.1 lbs	10810050734889
ASD-MPLR-346-FA-6PACK	New construction flat mounting plate with asymmetric round holes 3-4-6"	810050739344	24 (6)	14.4" x 9.8" x 3.2"	18.1 lbs	10810050739341
ASD-MPLR-18-346-FA-6PACK	New construction flat mounting plate 18" with asymmetric round holes 3-4-6"	810128112826	24 (6)	18.9" x 9.8" x 3.2"	32.9 lbs	10810128112823
ASD-MPLS-346-FA-6PACK	New construction flat mounting plate with asymmetric square holes 3-4-6"	810128110303	24 (6)	14.4" x 9.8" x 3.2"	17.7 lbs	10810128110300
ASD-MPLR-81012-FA-6PACK	New construction flat mounting plate with asymmetric round holes 8-10-12"	810128111553	24 (6)	19.5" x 14.2" x 3.2"	37.2 lbs	10810128111550
ASD-MPLS-81012-FA-6PACK	New construction flat mounting plate with asymmetric square holes 8-10-12"	810128112833	24 (6)	19.5" x 14.2" x 3.2"	36.3 lbs	10810128112830
ASD-MPLR-346-FS-6PACK	New construction flat mounting plate with symmetric round holes 3-4-6"	810050739351	24 (6)	27" x 9.1" x 3.2"	21 lbs	10810050739358
ASD-MPLS-346-FS-6PACK	New construction flat mounting plate with symmetric square holes 3-4-6"	810128110310	24 (6)	27" x 9.1" x 3.2"	20.7 lbs	10810128110317
ASD-MPLR-81012-FS-6PACK	New construction flat mounting plate with symmetric round holes 8-10-12"	810128111577	24 (6)	27" x 13.8" x 3.2"	42.3 lbs	10810128111574
ASD-MPLS-81012-FS-6PACK	New construction flat mounting plate with symmetric square holes 8-10-12"	810128112840	24 (6)	27" x 13.8" x 3.2"	40.7 lbs	10810128112847
ASD-MPLR-346-SC-6PACK	New construction mounting plate with round holes and sliding clips 3-4-6"	810050739337	12 (6)	17.3" x 11.9" x 13.4"	17 lbs	10810050739334
ASD-MPLS-346-SC-6PACK	New construction mounting plate with square holes and sliding clips 3-4-6"	810128110327	12 (6)	17.3" x 11.9" x 13.4"	16.5 lbs	10810128110324
ASD-MPLR-81012-SC-6PACK	New construction mounting plate with round holes and sliding clips 8-10-12"	810128111607	12 (6)	21.3" x 17.5" x 15.6"	24 lbs	10810128111604
ASD-MPLS-81012-SC-6PACK	New construction mounting plate with square holes and sliding clips 8-10-12"	810128118040	12 (6)	21.3" x 17.5" x 15.6"	24 lbs	10810128118047

ANNEX 1

Model	Watts	2,700 K	3,000 K	3,500 K	4,000 K	5,000 K
ASD-CDL7R-6A30WH	12W	1,332 lm	1,351 lm	1,393 lm	1,423 lm	1,450 lm
	16W	1,737 lm	1,771 lm	1,832 lm	1,873 lm	1,915 lm
	22W	2,320 lm	2,377 lm	2,459 lm	2,502 lm	2,527 lm
	26W	2,641 lm	2,715 lm	2,813 lm	2,861 lm	2,881 lm
	30W	3,018 lm	3,119 lm	3,242 lm	3,304 lm	3,352 lm
ASD-CDL7R-8A35WH	16W	1,928 lm	1,953 lm	2,015 lm	2,095 lm	2,613 lm
	22W	2,569 lm	2,613 lm	2,702 lm	2,757 lm	2,796 lm
	26W	2,702 lm	2,796 lm	3,048 lm	3,205 lm	3,241 lm
	30W	3,377 lm	3,452 lm	3,578 lm	3,645 lm	3,681 lm
ASD-CDL7R-10A40WH	35W	3,838 lm	3,935 lm	4,093 lm	4,178 lm	4,246 lm
	22W	2,644 lm	2,691 lm	2,842 lm	2,999 lm	3,162 lm
	26W	2,999 lm	3,058 lm	3,162 lm	3,219 lm	3,260 lm
	30W	3,260 lm	3,459 lm	3,640 lm	3,679 lm	3,863 lm
ASD-CDL7S-6A30WH	35W	3,960 lm	4,103 lm	4,167 lm	4,200 lm	4,363 lm
	40W	4,363 lm	4,487 lm	4,659 lm	4,736 lm	4,791 lm
	12W	1,190 lm	1,202 lm	1,234 lm	1,255 lm	1,274 lm
	16W	1,639 lm	1,669 lm	1,720 lm	1,750 lm	1,780 lm
ASD-CDL7S-8A35WH	22W	2,270 lm	2,330 lm	2,407 lm	2,438 lm	2,442 lm
	26W	2,639 lm	2,721 lm	2,818 lm	2,851 lm	2,839 lm
	30W	2,992 lm	3,101 lm	3,218 lm	3,257 lm	3,273 lm
	16W	1,715 lm	1,731 lm	1,781 lm	1,815 lm	1,846 lm
ASD-CDL7S-10A40WH	22W	2,399 lm	2,458 lm	2,495 lm	2,534 lm	2,557 lm
	26W	2,798 lm	2,854 lm	2,948 lm	2,991 lm	3,007 lm
	30W	3,209 lm	3,283 lm	3,399 lm	3,445 lm	3,450 lm
	35W	3,711 lm	3,816 lm	3,969 lm	4,094 lm	4,046 lm
ASD-CDL7R-6A30WH-EM	12W	1,332 lm	1,351 lm	1,393 lm	1,423 lm	1,450 lm
	16W	1,737 lm	1,771 lm	1,832 lm	1,873 lm	1,915 lm
	22W	2,320 lm	2,377 lm	2,459 lm	2,502 lm	2,527 lm
	26W	2,641 lm	2,715 lm	2,813 lm	2,861 lm	2,881 lm
ASD-CDL7R-8A35WH-EM	30W	3,018 lm	3,119 lm	3,242 lm	3,304 lm	3,352 lm
	16W	1,928 lm	1,953 lm	2,015 lm	2,095 lm	2,613 lm
	22W	2,569 lm	2,613 lm	2,702 lm	2,757 lm	2,796 lm
	26W	2,702 lm	2,796 lm	3,048 lm	3,205 lm	3,241 lm
ASD-CDL7R-10A40WH-EM	30W	3,377 lm	3,452 lm	3,578 lm	3,645 lm	3,681 lm
	35W	3,838 lm	3,935 lm	4,093 lm	4,178 lm	4,246 lm

For most up-to-date spec sheets please refer to asd-lighting.com

ASD LIGHTING CORP

E-mail: orders@asd-lighting.com | Web site: www.asd-lighting.com

