

0-10V TO REVERSE PHASE CONVERTER

LDCM-PL-120-277-010V

Dims Reverse Phase Only
Fixtures with 0-10V Input

Direct J-Box Mount



Plenum Rated

120V and 277V Auto-Sensing



DESCRIPTION

The LDCM-PL-120-277-010V takes a 0-10V dimming signal and a fixed line voltage input and converts it to a reverse phase dimmed output for up to 1000W for a 277V load and 450W for a 120V load. One LDCM-PL can be used per run up to the maximum wattage. The LDCM-PL is rated to directly mount to a junction box in a plenum space for easier installations and to meet building requirements.

OPERATION

The LDCM-PL supports 120V or 277V loads and automatically senses input voltage, eliminating any need for configuration of the device. As the 0-10V control input increases/decreases in voltage, the LDCM-PL will adjust the phase-cut signal to follow.

APPLICATIONS

The LDCM-PL is used with 0-10V control devices like LMRC room controllers to dim reverse phase fixtures. Multi-zone 0-10V room controllers like the LMRC-212 can support multiple load types by converting one output to reverse phase with the LDCM-PL, and leaving the other unconverted to control 0-10V loads. The LDCM-PL is mounted to a standard 1/2" knockout.

SPECIFICATIONS

- Voltage: 110-120VAC, 277VAC; 60Hz
- Power: 450W at 110-120VAC, 1000W at 277VAC
- Control: 0-10V Input
- Housing: Injection Molded Polycarbonate
- Operating Temperature: -4°F to 104°F (-20°C to 40°C)
- Weight: 0.99 lbs (0.45 kg)
- Mounting: 1/2" Knockout Nipple Mount
- Environment: ETL/cETL Damp Location
- The product meets the materials restrictions of RoHS
- Plenum Rated
- Five Year Warranty

PROJECT

LOCATION/
TYPE

DIMENSIONS

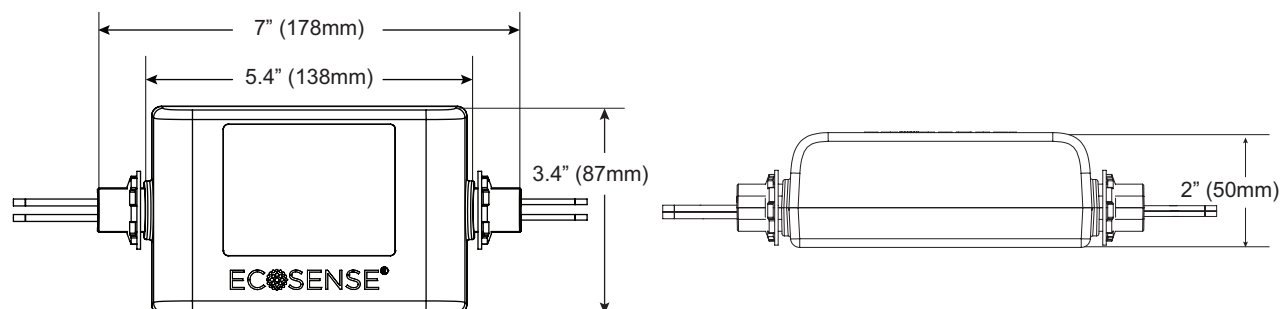

CONNECTIONS

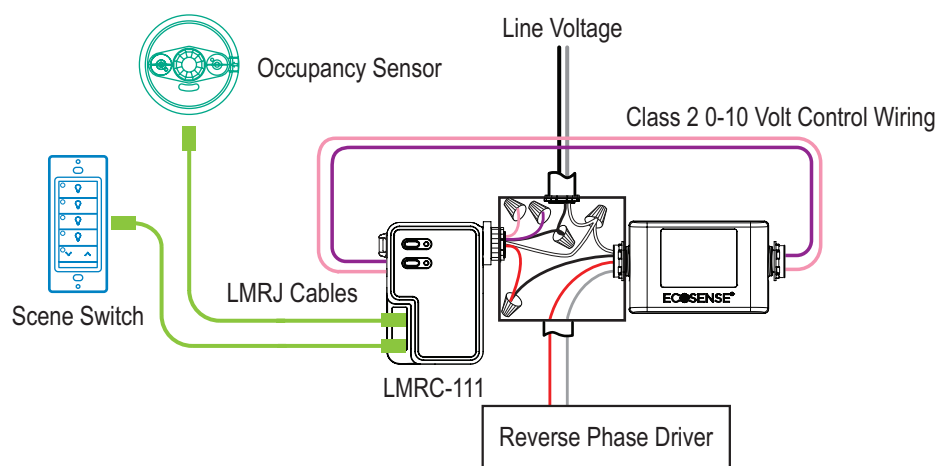

Example with a Wired Room Controller and Class 2 Dimming

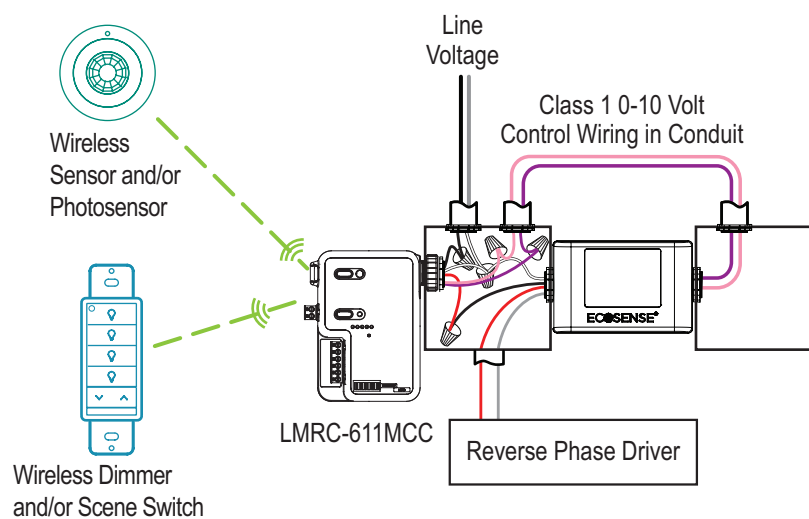

Example with a Wireless Room Controller and Class 1 Dimming

ORDERING INFORMATION

Catalog #	Description
LDCM-PL-120-277-010V	0-10V to Reverse Phase Converter