

Project Name:	Type:
Part Number:	Date:

SELECTFIT G3 SERIES

SPECIFICATION FEATURES

- Mechanical** - SELECTFIT Downlight made from die cast aluminum, for maximizing passive cooling ensuring long life lasting LED. Post painted in matte white for standard fixture. This series is designed for remodel, direct mounting in the ceiling or for retrofitting existing commercial housings. Proprietary integrated IC-rated potted driver for optimal heat protection and ensure long life of electronics components. Stainless steel spring action clips allow for both easy direct installation from 1/2" to 2" ceiling thicknesses and field accessibility below the ceiling for service or replacement.
- Electrical** - Field select from three lumen outputs using SelectDrive technology. The driver features DualDim Technology, for maximum adaptability in any spaces whether it's commercial, residential or mixed. Rated for 120 to 277V, 50/60 Hz the driver is both 0-10V dimmable, Forward and Reverse phase dimmable at 120V. Please consult dimmer compatibility for additional information. Sound rating <22db.
- Optical** - Self flanged spun aluminum reflector, painted with high reflection matte white. Clear aluminum or wall wash trim insert available for field installation. High resistance and non yellowing polycarbonate lenses for optimal low glare light diffusion. Featuring SelectKelvin technology with field selectable CCTs 2700/3000/3500/4000/5000K. LED binning within 3 SDCM maximum. Offered in minimum 90 CRI. 90° optical wide beam angle.
- Thermal** - Die cast heat sink maximizes passive thermal management and achieves a L70 rated lifetime of 100,000 hours, at 25°C, meeting TM-21-19 requirements. Ambient temperature rated from -40°F to 113°F (-40°C to 45°C). IC installation for IC rated parts limited to +35°C (95.0°F) ambient temperature.
- Compliance and Warranty** - ETL Classified and Listed for wet location from the bottom under covered ceilings. Certified air-tight per ASTM 283-04. Complies with FCC 47CFR Part 15B consumer limits for EMI/RFI emissions at 120V. Suitable for use in clothes closets when installed in accordance with the NEC 410.16 spacing requirements. 4", 6" and 8" are certified IC for direct contact with insulation. 6" HO, 8" HO and 9.5" are not IC rated. Can be used for State of California Title 24 high efficacy LED compliance under JA8. ENERGY STAR® certified. 5 Year Warranty for complete fixture. Optional 10 Year Extended Warranty available, subject to same terms, conditions and installation requirements as standard 5 Year Warranty.

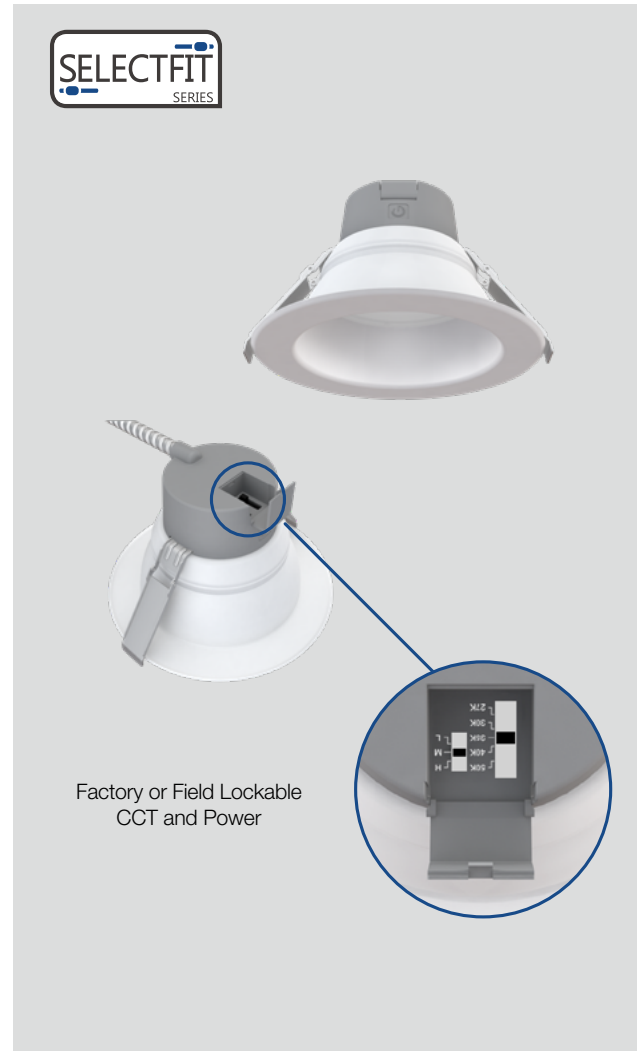

041425



BENEFITS

- DualDim technology provides the easiest remodeling, direct mount or retrofitting installation dimming compatibility
- SelectKelvin technology to choose from five color temperatures ranging from 2700K to 5000K
- SelectDrive technology allow to select from 3 lumen outputs
- Install virtually anywhere with Wet Location, IC rated models and Air-tight ratings
- Factory or Field Lockable CCT and Power.

APPLICATIONS

- Commercial
- Retail
- Hospitality
- Education
- Outdoor under covered ceilings



SELECTFIT G3 SERIES

ORDERING INFORMATION						
SLFT(size+lumen output)		(CRI+CCT)		(Driver+Options)		
SLFTG3/6/9CCT5S/DUALDIM						
Series	Size	Factory Lumen Lock	CRI	CCT	Driver	Options
SLFTG3 SELECTFIT Round Downlight	4 4" 900/750/650lm	(Blank) Leave Blank if you want to select the lumen output on the field	9 CRI 90+	CCT5S Selectable 2700/3000/3500 /4000/5000K	DUALDIM 120V-277V, 50/60Hz. 0-10V or Forward/ Reverse phase dimming at 120V only	NURO/RCM¹ NUROAir Ready Power Pack for Ceiling Mount Sensor
	6 6" 1700/1300/1000lm	L Factory Set Low Output (4" - 650lm / 6" - 1000lm / 6" HO - 1750lm / 8" 1200lm / 8" HO - 2900lm / 9.5" - 2400lm)		F27 Factory set 2700K		
	6HO 6" 2900/2300/1750lm	M Factory Set Medium Output (4" - 750lm / 6" - 1300lm / 6" HO - 2300lm / 8" 1600lm / 8" HO - 3600lm / 9.5" - 3200lm)		F30 Factory set 3000K		
	8 8" 2100/1600/1200lm	H Factory Set High Output (4" - 900lm / 6" - 1700lm / 6" HO - 2900lm / 8" 2100lm / 8" HO - 4200lm / 9.5" - 4000lm)		F35 Factory set 3500K		
	8HO 8" 4200/3600/2900lm			F40 Factory set 4000K		
	9.5 9.5" 4000/3200/2400lm			F50 Factory set 5000K		

1. This option needs to be selected for each fixture to use with NURO7/CM.

Note: Factory setting at highest lumen output and 3500K CCT.

NUROAir CONTROLS ORDERING GUIDE

Control	Switches
NURO7/CM¹ NUROAir Bluetooth Ceiling Mount Dual Mode Sensor	NURO-SW-3B-BT-BLE-WP-V1 NUROAir 3-Button Bluetooth Battery Powered Wall Switch
	NURO-SW-5B-BT-BLE-WP-V1 NUROAir 5-Button Bluetooth Battery Powered Wall Switch
	NURO-SW-7B-BT-BLE-WP-V1 NUROAir 7-Button Bluetooth Line Voltage (AC 120-277V) Powered Wall Switch

1. 600 sq ft sensor coverage

NUROAir by ILLUMUS

NUROAir Bluetooth Ceiling Mount Dual Mode Sensor is the optimal groupable controls lighting solution. With main features such as PIR Motion and Ultrasonic Sensing, Occupancy/Vacancy, Bi-Level Dimming and Daylight Harvesting - this flexibility makes the NUROAir Bluetooth Ceiling Mount Dual Mode Sensor ideal for tailoring lighting to specific space needs, optimizing both ambiance and efficiency. The NUROAir App, available for download on iOS and Google Play Store, offers a user-friendly interface for automatic or manual customization of your space. Through the app, users can configure sensor settings such as the Light Output, CCT, Hold Time, Standby Time/Level, High/Low End Trim, Background Light Level, Set Schedules, and Control Lighting Groups or Zones, all from a mobile or tablet device. Manual control is also available with a range of compatible wireless & wired wall switch options.



Click Here or Scan Code
to Learn More About
NUROAir Bluetooth Controls



SELECTFIT G3 SERIES

LINE DRAWING

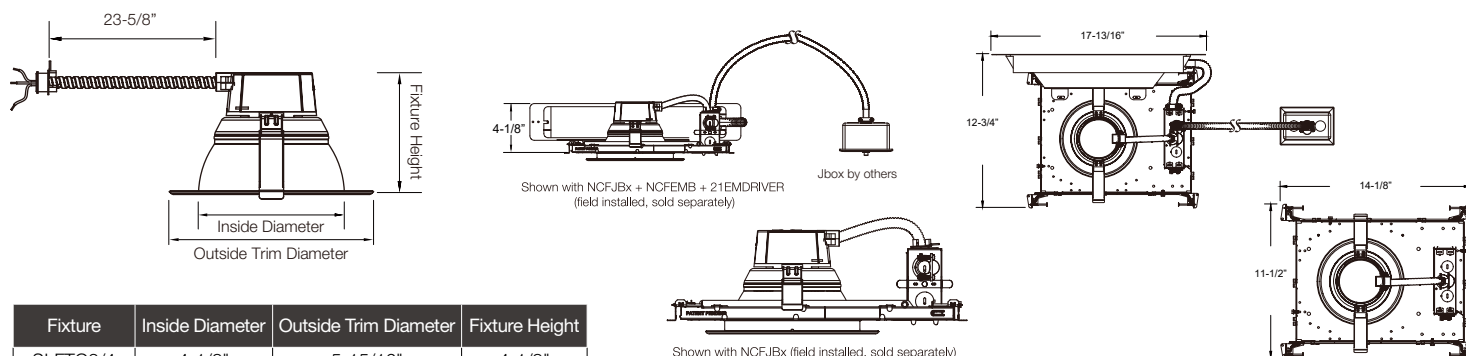

Fixture	Inside Diameter	Outside Trim Diameter	Fixture Height
SLFTG3/4	4-1/8"	5-15/16"	4-1/8"
SLFTG3/6	6-1/16"	8-1/4"	4-15/16"
SLFTG3/6HO	6-1/16"	8-1/4"	4-15/16"
SLFTG3/8	7-5/8"	10-1/4"	5-11/16"
SLFTG3/8HO	7-5/8"	10-1/4"	5-11/16"
SLFTG3/9.5	8-5/8"	11-3/8"	6-3/16"

Remodel /Retrofit/Direct Mount Ceiling Cutout						
Type	SLFTG3/4	SLFTG3/6	SLFTG3/6HO	SLFTG3/8	SLFTG3/8HO	SLFTG3/9.5
Minimum	4-1/8"	6-1/8"	6-1/8"	7-11/16"	7-11/16"	8-11/16"
Maximum	5-1/8"	7-1/2"	7-1/2"	9-7/16"	9-7/16"	10-7/16"

TECHNICAL INFORMATION

Type	Dimming	Input Voltage	Input Frequency	Input Current	Input Power	THD Power	Power Factor	Flicker Index	Sound Rating
4"	0-10V and ELV/TRIAC	120-277V	50-60Hz	0.095A	10/8/7W	<20%	>0.9	<30%	<22db
6"				0.15A	17/13.5/10W				
6" HO				0.285A	30/24/18W				
8"				0.19A	20/16/12W				
8" HO				0.38A	42.5/37/30W				
9.5"				0.38A	40/32/24W				

NOMINAL PERFORMANCE

Product	Wattage (W)	2700K		3000K		3500K		4000K		5000K	
		Lumens (lm)	Efficacy (LPW)	Lumens (lm)	Efficacy (LPW)	Lumens (lm)	Efficacy (LPW)	Lumens (lm)	Efficacy (LPW)	Lumens (lm)	Efficacy (LPW)
SLFTG3/4	7	600	7	610	7	7	7	7	7	7	
	8	700	8	710	8	8	8	8	8	8	
	10	800	10	840	10	10	10	10	10	10	
SLFTG3/6	10	900	10	930	10	10	10	10	10	10	
	13.5	1,200	13.5	1,250	13.5	13.5	13.5	13.5	13.5	13.5	
	17	1,500	17	1,580	17	17	17	17	17	17	
SLFTG3/6HO	18	1,650	18	1,700	18	18	18	18	18	18	
	24	2,000	24	2,100	24	24	24	24	24	24	
	30	2,600	30	2,800	30	30	30	30	30	30	
SLFTG3/8	12	1,000	12	1,100	12	12	12	12	12	12	
	16	1,400	16	1,500	16	16	16	16	16	16	
	20	1,850	20	1,950	20	20	20	20	20	20	
SLFTG3/8HO	30	2,650	30	2,750	30	30	30	30	30	30	
	37	3,250	37	3,350	37	37	37	37	37	37	
	42.5	3,800	42.5	3,800	42.5	42.5	42.5	42.5	42.5	42.5	
SLFTG3/9.5	24	2,100	24	2,200	24	24	24	24	24	24	
	32	2,900	32	3,000	32	32	32	32	32	32	
	40	3,600	40	3,700	40	40	40	40	40	40	



SELECTFIT G3 SERIES

ACCESSORY ORDERING INFORMATION				
Product	Model	Description	Pictures	Dimensions
37041	SLFT4/CL/TRIM	SELECFIT G2 4" Field Installable flangeless clear trim insert (Clips inside the reflector for Clear + White Flange finish)		
37042	SLFT6/CL/TRIM	SELECFIT G2 6" Field Installable flangeless clear trim insert (Clips inside the reflector for Clear + White Flange finish)		
37043	SLFT8/CL/TRIM	SELECFIT G2 8" Field Installable flangeless clear trim insert (Clips inside the reflector for Clear + White Flange finish)		
35160	SLFT/TRIM9.5/CC	Field installable 9.5" Clear Trim and flange Insert (Attaches on the flange for clear + clear flange finish)		
37039	SLFT4/WW/ACC	SELECFIT G2 4" Field installable Wall Wash white insert (wall wash insert can not be combined with Trim insert)		
37040	SLFT6/WW/ACC	SELECFIT G2 6" Field installable Wall Wash white insert (wall wash insert can not be combined with Trim insert)		
35121	NCFJB4	4" New Construction Frame for T-Grid ceilings and stud/joist mounting		
35122	NCFJB6	6" New Construction Frame for T-Grid ceilings and stud/joist mounting		
35123	NCFJB8	8" New Construction Frame for T-Grid ceilings and stud/joist mounting		
35124	NCFJB9.5	9.5" New Construction Frame for T-Grid ceilings and stud/joist mounting		
35126	NCFBFB	Field Installable Butterfly Brackets For New Construction Frame		
35125	NCFEMB	Field Installable Emergency Bracket For New Construction Frame		



SELECTFIT G3 SERIES

ACCESSORY ORDERING INFORMATION

Product	Model	Description	Pictures	Dimensions
98280	NCDL46RPLATE	4" & 6" New Construction Plate for Stud/Joist Mounting		<p>A: Ø4-5/8" B: Ø4-3/16" C: Ø6-7/16" D: Ø6"</p>
98501	NCPLATE/T4689	New Construction or Remodel Plate for T-Grid Ceilings		<p>A: Ø4-5/16" B: Ø6-5/16" C: Ø8-1/16" D: Ø9"</p>
98569	GOOFRING4	4" Goof Ring - Outer Diameter 8-1/8"		
98568	GOOFRING6	6" Goof Ring - Outer Diameter 10-1/2"		
98567	GOOFRING8	8" Goof Ring - Outer Diameter 12-1/2"		
98566	GOOFRING9.5	9.5" Goof Ring - Outer Diameter 14-3/16"		
37934	8EMINVERTER	California Title 20 Compliant 8W Emergency LED Inverter (Field Installation)		
37935	21EMINVERTER	California Title 20 Compliant 21W Emergency LED Inverter (Field Installation)		
FHUPS1-UNV-25L-SD	FHUPS1-UNV-25L-SD	25W Emergency Micro Inverter for field installation to use with 0-10V Driver options. 100-277VAC (up to 150W with use of 0-10V dimming). CEC Compliant		

LOGISTIC INFORMATION

Product	Model	Case Quantity
38633	SLFTG3/4/9CCT5S/DUALDIM	6pcs
38634	SLFTG3/6/9CCT5S/DUALDIM	6pcs
38635	SLFTG3/6HO/9CCT5S/DUALDIM	6pcs
38636	SLFTG3/8/9CCT5S/DUALDIM	6pcs
38637	SLFTG3/8HO/9CCT5S/DUALDIM	6pcs
38638	SLFTG3/9.5/9CCT5S/DUALDIM	6pcs



SELECTFIT G3 SERIES

PHOTOMETRY

SLFTG3/4/9CCT5S/DUALDIM

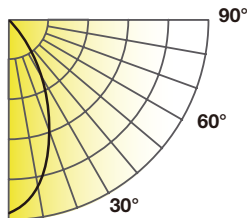

Lumens: 965 lm
CBCP: 531 cd
Power: 10 W
Efficacy: 98 lm/W
CRI: 92
Spacing Criteria: 1.1
Beam Angle: 81°

Candlepower Distribution		Candlepower Distribution		
Angle (°)	Average (cd)	Height (ft)	Fc	Diameter (ft)
10	517	10	8	17
20	471	20	2	34
30	379	30	1	51
40	269	40	0	68
50	171	50	0	85
60	89	60	0	102
70	44	70	0	119
80	14	80	0	135
90	0	90	0	152

Zonal Lumen Summary		
Zone	Lumens	%Fixt
0-10	50	5
0-20	190	20
0-30	386	40
0-60	866	90
0-90	965	100

SLFTG3/6/9CCT5S/DUALDIM

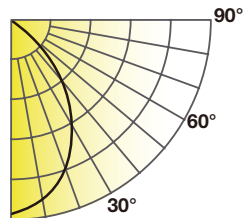

Lumens: 2,031 lm
CBCP: 1,087 cd
Power: 18 W
Efficacy: 122 lm/W
CRI: 92
Spacing Criteria: 1.1
Beam Angle: 84°

Candlepower Distribution		Candlepower Distribution		
Angle (°)	Average (cd)	Height (ft)	Fc	Diameter (ft)
10	1,058	10	16	18
20	973	20	4	36
30	815	30	2	54
40	588	40	1	71
50	351	50	1	89
60	169	60	0	107
70	85	70	0	125
80	35	80	0	143
90	0	90	0	161

Zonal Lumen Summary		
Zone	Lumens	%Fixt
0-10	102	5
0-20	390	19
0-30	804	40
0-60	1,831	90
0-90	2,028	100

SLFTG3/6HO/9CCT5S/DUALDIM

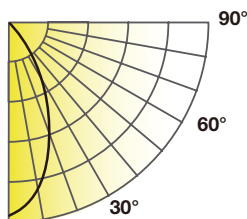

Lumens: 3,569 lm
CBCP: 1,911 cd
Power: 30 W
Efficacy: 124 lm/W
CRI: 92
Spacing Criteria: 1.1
Beam Angle: 83°

Candlepower Distribution		Candlepower Distribution		
Angle (°)	Average (cd)	Height (ft)	Fc	Diameter (ft)
10	1,858	10	28	18
20	1,705	20	7	36
30	1,416	30	3	53
40	1,014	40	2	71
50	615	50	1	89
60	299	60	1	107
70	154	70	1	124
80	63	80	0	142
90	0	90	0	160

Zonal Lumen Summary		
Zone	Lumens	%Fixt
0-10	180	5
0-20	685	19
0-30	1,409	40
0-60	3,208	90
0-90	3,563	100

SLFTG3/8/9CCT5S/DUALDIM

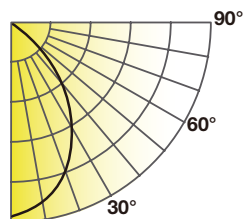

Lumens: 2,031 lm
CBCP: 1,087 cd
Power: 18 W
Efficacy: 122 lm/W
CRI: 92
Spacing Criteria: 1.1
Beam Angle: 84°

Candlepower Distribution		Candlepower Distribution		
Angle (°)	Average (cd)	Height (ft)	Fc	Diameter (ft)
10	1,230	10	18	18
20	1,126	20	5	36
30	960	30	2	54
40	687	40	1	72
50	395	50	1	89
60	179	60	1	107
70	86	70	0	125
80	41	80	0	143
90	0	90	0	161

Zonal Lumen Summary		
Zone	Lumens	%Fixt
0-10	102	5
0-20	390	19
0-30	804	40
0-60	1,831	90
0-90	2,028	100



SELECTFIT G3 SERIES

PHOTOMETRY

SLFTG3/8HO/9CCT5S/DUALDIM

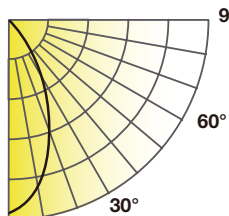

Candlepower Distribution		Candlepower Distribution		
Angle (°)	Average (cd)	Height (ft)	Fc	Diameter (ft)
10	3,233	10	48	13
20	2,662	20	12	27
30	2,006	30	5	40
40	1,329	40	3	53
50	705	50	2	67
60	300	60	1	80
70	124	70	1	93
80	59	80	1	107
90	0	90	1	120

Lumens: 4,790 lm
CBCP: 3,495 cd
Power: 40 W
Efficacy: 123 lm/W
CRI: 92
Spacing Criteria: 0.9
Beam Angle: 67°

Zonal Lumen Summary		
Zone	Lumens	%Fixt
0-10	321	7
0-20	1,153	24
0-30	2,230	47
0-60	4,465	93
0-90	4,781	100

SLFTG3/9.5/9CCT5S/DUALDIM

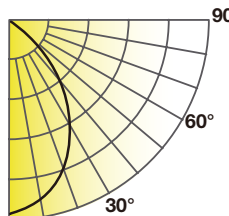

Candlepower Distribution		Candlepower Distribution		
Angle (°)	Average (cd)	Height (ft)	Fc	Diameter (ft)
10	2,220	10	33	22
20	2,095	20	8	43
30	1,843	30	4	65
40	1,469	40	2	87
50	987	50	1	108
60	492	60	1	130
70	228	70	1	151
80	109	80	1	173
90	0	90	0	195

Lumens: 4,952 lm
CBCP: 2,260 cd
Power: 40 W
Efficacy: 131 lm/W
CRI: 92
Spacing Criteria: 1.2
Beam Angle: 95°

Zonal Lumen Summary		
Zone	Lumens	%Fixt
0-10	214	4
0-20	825	17
0-30	1,738	35
0-60	4,388	89
0-90	4,942	100

Note: All rights reserved. All sizes and specifications are subject to change at any time without notice.