

## MaxLite® Slim Bollard Series



### General Safety Information

#### WARNING:

- To reduce the risk of death, personal injury or property damage from fire, electric shock, falling parts, cuts/abrasions, and other hazards read all warnings and instructions included with and on the fixture box and all fixture labels.
- Before installing, servicing, or performing routine maintenance upon this equipment, follow these general precautions.
- Commercial installation, service and maintenance of luminaires should be performed by a qualified licensed electrician.
- For the installation: If you are unsure about the installation or maintenance of the luminaires, consult a qualified licensed electrician and check your local electrical code.
- To prevent wiring damage or abrasion, do not expose wiring to edges of sheet metal or other sharp objects.
- Do not make or alter any open holes in an enclosure of wiring or electrical components during kit installation.
- Turn off electrical power at fuse or circuit breaker box before wiring fixture to the power supply.
- Turn off the power when you perform any maintenance.
- Verify that supply voltage is correct by comparing it with the luminaire label information.
- All wiring connections should be capped with UL approved wire connectors.



*Pictures are for illustration purposes only. Your model may vary.*

#### CAUTION:

##### RISK OF INJURY

- Wear gloves and safety glasses at all times when removing luminaire from carton, installing, servicing or performing maintenance.
- Avoid direct eye exposure to the light source while it is on.
- Account for small parts and destroy packing material, as these may be hazardous to children.

#### CAUTION:

##### RISK OF FIRE

- Avoid direct eye exposure to the light source while it is on.
- Account for small parts and destroy packing material, as these may be hazardous to children.
- Risk of burn. Disconnect power and allow fixture to cool before changing bulb or handing fixture.

##### RISK OF FIRE, EXPLOSION AND ELECTRIC SHOCK

- This product should be installed, inspected, and maintained by a qualified electrician only, in accordance with the NEC (National Electric Code) and all local codes.
- Turn off electrical power before inspection, installation or removal.
- Use only UL (or other NRTL) approved wire for input/output connections. Minimum size 18 AWG or 14 AWG for continuous runs.
- Make sure LEDs and drivers are cool to touch when performing maintenance. Make sure the supply voltage is the same as the rated voltage of the luminaire.
- Do not install in a hazardous atmosphere, except where the ambient temperature does not exceed the rated operating temperature of the fixture.
- Keep tightly closed when in operation

#### Models:

This instruction manual applies to the PathMAX Series Round - Dome & Flat Top Slim Bollards

# MaxLite® Slim Bollard Series: Stilt - Single and Three Leg



## General Wiring Diagram

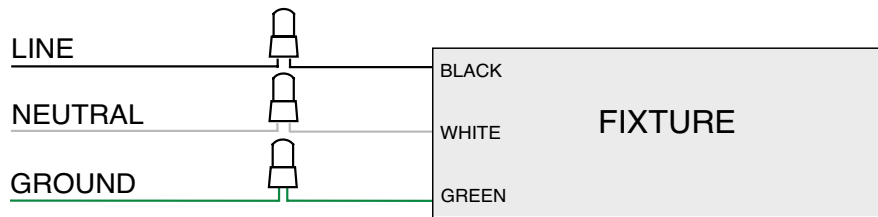

## Electrical Requirements

The LED driver must be supplied with the voltage specified on the product label and connected to an individual, properly grounded branch circuit protected by a 20 Ampere circuit breaker. Use min. 75°C supply.

## Grounding Instructions

The grounding and bonding of the overall system shall be done in accordance with NEC Article 600 and local codes.

## Installation Instructions - BS[1,3]30U-WCS

Tools Required: Wire Strippers, Wire Cutters, Bubble Level, Flat Head Screwdriver, Phillips Screwdriver, Drill with Assorted Bits, and Socket Wrench or Crescent Wrench

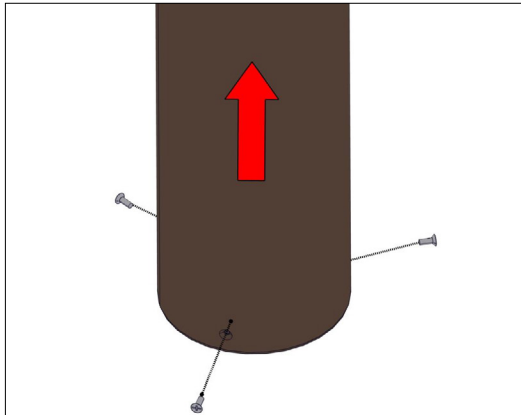
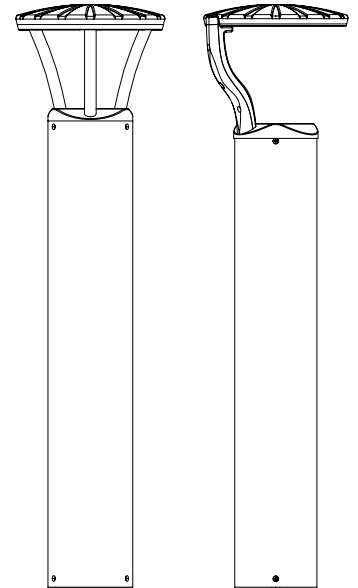

1. Remove the three screws at the bottom of the bollard.

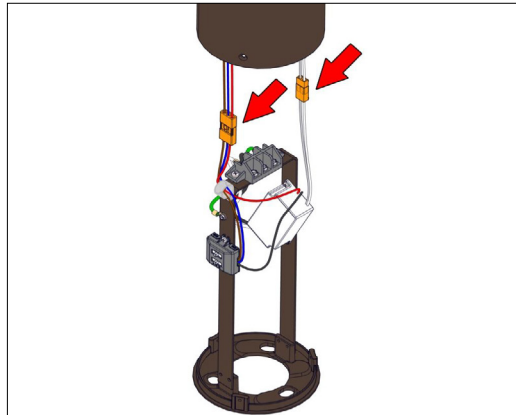

2. Carefully lift the fixture from the mounting base and disconnect the orange connectors. Adjust the FAO to the desired CCT and wattage settings.

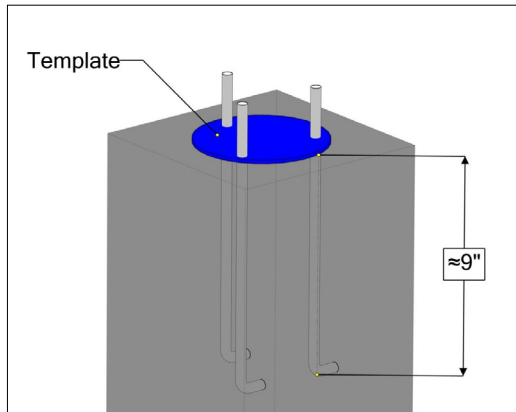
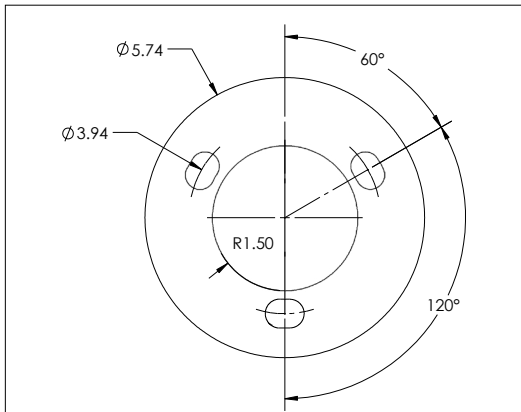

3. Install the provided anchor bolts in concrete using the template for correct placement. The bolts should be approximately 9" below ground. Make sure the supply circuit is already run before pouring.

# MaxLite® Slim Bollard Series: Stilt - Single and Three Leg



## Installation Instructions - BS[1,3]30U-WCS - Continued

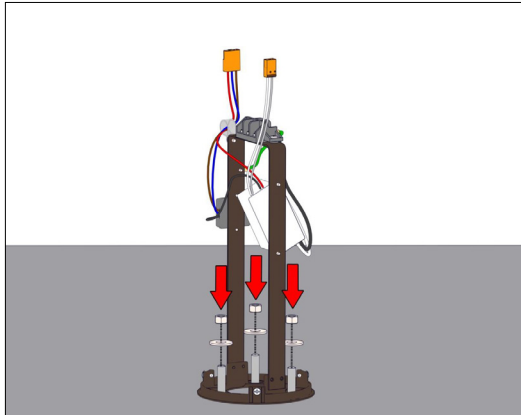

4. Secure the mounting base to the anchor bolts using the provided washers and hex nuts.

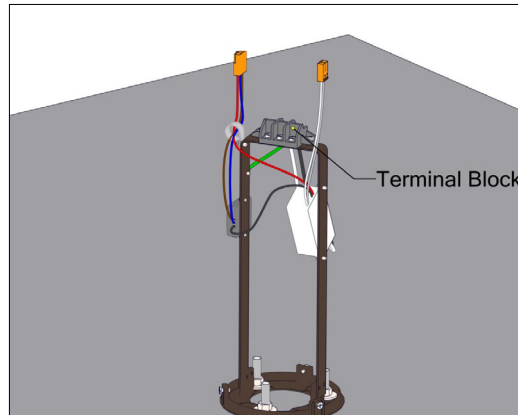

5. Make the electrical connections from the supply using the pre-installed terminal block. Refer to the wiring diagram on Page 2.

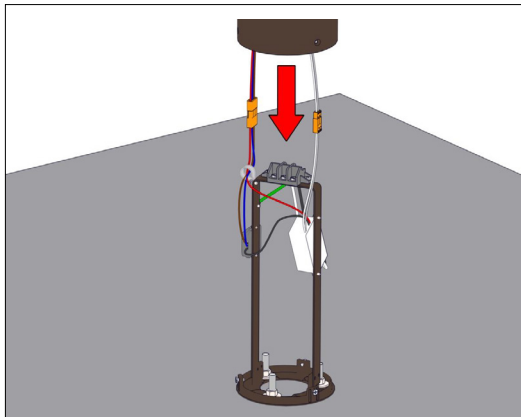

6. Re-install the fixture to the mounting base, making sure to reconnect the orange connectors. Secure with the three screws removed in Step 1.

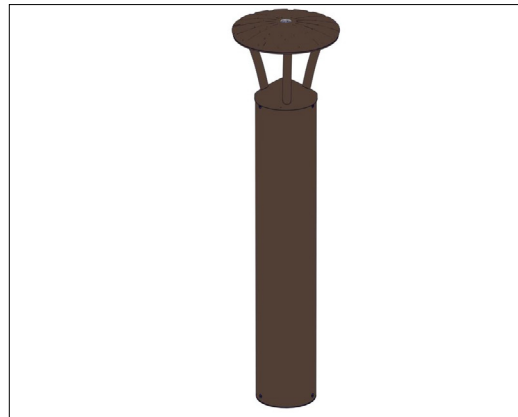

7. Restore power and check that the fixture is functioning properly.

## Photocontrol Adjustments

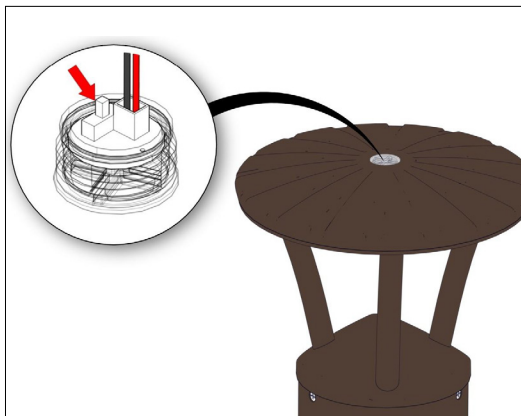

1. With the supply power off, unscrew the photocontrol carefully adjust the switch on the back side to enable or disable the photocontrol. Take care not to pull, pinch, or disconnect the harness wires. Replace the conduit plug.

NOTE: Replace the conduit plug securely to avoid water ingress.

# MaxLite® Slim Bollard Series: Round - Dome & Flat Top



## General Wiring Diagram

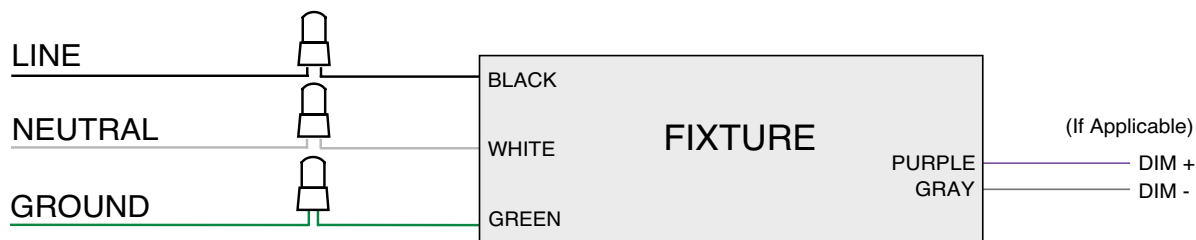

## Electrical Requirements

The LED driver must be supplied with the voltage specified on the product label and connected to an individual, properly grounded branch circuit protected by a 20 Ampere circuit breaker. Use min. 75°C supply.

## Grounding Instructions

The grounding and bonding of the overall system shall be done in accordance with NEC Article 600 and local codes.

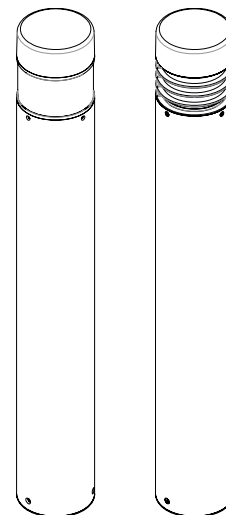

## Installation Instructions - BR [D,F] 30U-WCS

1. Before starting installation ensure that the power is disconnected.
2. Unpack fixture and ensure that there are no damaged parts.
3. Use the supplied cardboard template to set the anchor bolts in concrete.
4. Be sure that the base of the concrete is elevated from the surrounding area to keep the bollard from standing in water. Allow concrete to properly set.
5. Remove the 3 grub screws from the bollard to remove the base assembly. Be sure to disconnect the orange disconnect from the cable on the terminal block.
6. Once the base is removed, it can be installed onto the anchor bolts that were previously set in.
7. Bolt down the base using the included nuts and washers.
8. Once secured, attach the main connections to the terminal block on the top of the base. Be sure to connect the cables as below Black to Black (Hot), White to White (Neutral), Green to Green (Ground).
9. Once everything is connected, replace the bollard body back onto the base and secure with the 3 grub screws below.

## Mounting Template

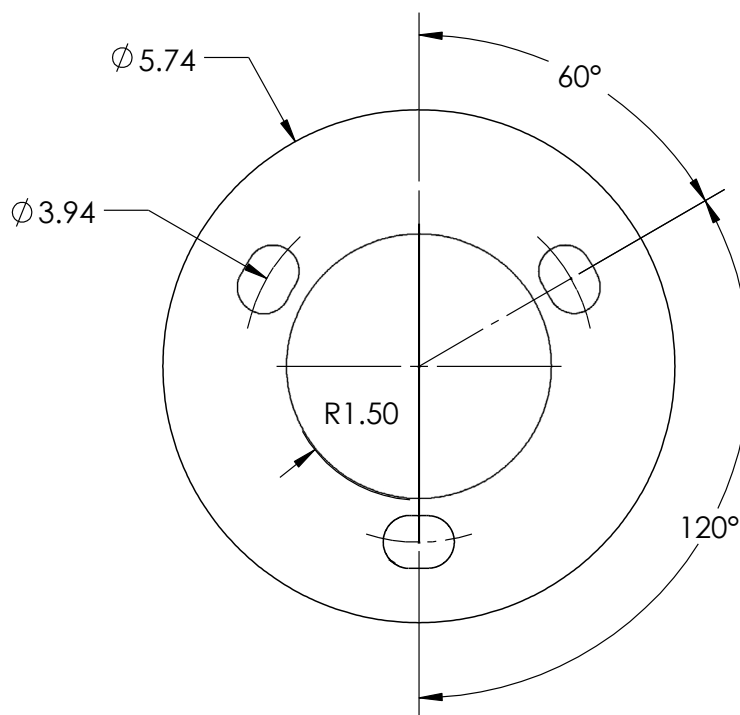

# MaxLite® Slim Bollard Series: Square - Flat Top



## General Wiring Diagram

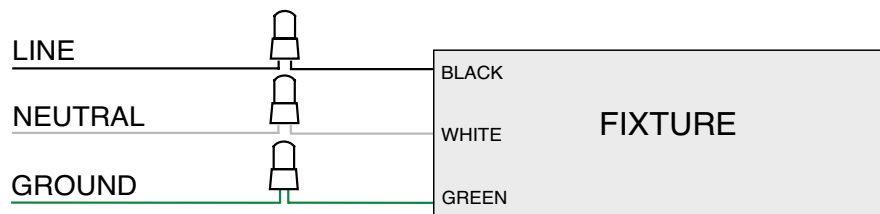

## Electrical Requirements

The LED driver must be supplied with the voltage specified on the product label and connected to an individual, properly grounded branch circuit protected by a 20 Ampere circuit breaker. Use min. 75°C supply.

## Grounding Instructions

The grounding and bonding of the overall system shall be done in accordance with NEC Article 600 and local codes.

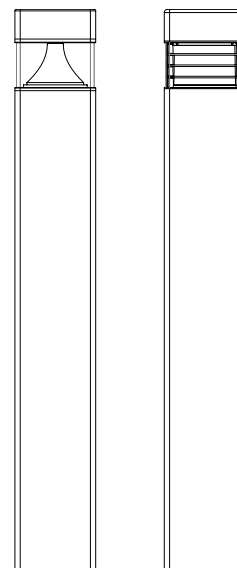

## Installation Instructions - BSF30U-WCS

Tools Required: Wire Strippers; Wire Cutters; Flat Head Screw driver; Bubble Level

1. Remove the four (4) screws near the bottom of the bollard and remove the base.
2. Unpack the hardware kit: (8) flat washers, (4) lock washers, (8) hex nuts, (4) 11" anchor bolts
3. Disconnect the orange quick-disconnects from the LED Driver and FAO and set the main housing aside.
4. Pour the concrete foundation. It should be a minimum of 12" in diameter, finished level and smooth, with a depth below grade of 24". Supply leads must extend a minimum of 31" above top of finished foundation.  
Note: The foundation should be slightly elevated from the surrounding area to keep the bollard from standing in water.
5. Use the supplied template to set the anchor bolts in the proper locations while the concrete is wet. Once the anchor bolts are positioned correctly, allow the concrete to completely dry. Note: The anchor bolts should project 2" vertically from the foundation.
6. Remove the template and install a hex nut and flat washer on each anchor bolt for leveling.
7. Guide the base over the anchor bolts and ensure it is level. Adjust the leveling nuts if needed.
8. Secure the base using the remaining flat washers, lock washers and hex nuts.
9. Wire the supply leads to the terminal block on the top of the base assembly. Adjust the FAO settings at this time.
10. Lift the main housing over the base, reconnect the quick-disconnects, and slide the housing onto the base.
11. Reinstall the four (4) screws to secure the bollard to the base.
12. Restore branch supply power and ensure the fixture functions properly. If the fixture does not turn on or function properly, shut off the branch supply power and recheck all electrical connections.

Mounting Template

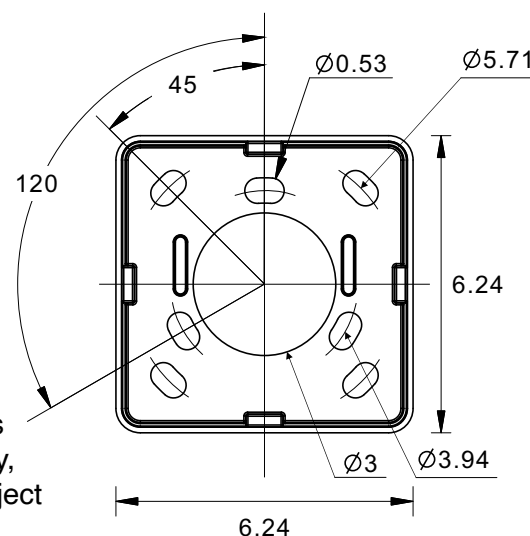

**MaxLite® Slim Bollard Series****Warranty Information**

MaxLite Inc. warrants its products for a minimum period of FIVE (5) years from the date of original purchase from MaxLite or its authorized distributor/dealer (the "Warranty Period"), as follows: If a Product fails to operate during the Warranty Period as a result of defects in materials or workmanship, MaxLite will, at its option, repair it, replace it with the same or like Product.

Please refer to Maxlite's website (at <http://maxlite.com/resources/warranties>) for the complete terms and conditions of our warranty.

**Limitation of Liability**

THE FOREGOING WARRANTY IS EXCLUSIVE, AND IS THE SOLE REMEDY FOR ANY AND ALL CLAIMS, WHETHER IN CONTRACT, IN TORT OR OTHERWISE ARISING FROM THE FAILURE OF PRODUCT AND IS IN LIEU OF ALL OTHER WARRANTIES, EXPRESS OR IMPLIED, INCLUDING ALL WARRANTIES OF MERCHANTABILITY OR FITNESS FOR A PARTICULAR PURPOSE, WHICH WARRANTIES ARE HEREBY EXPRESSLY DISCLAIMED TO THE EXTENT PERMITTED BY LAW AND, IN ANY EVENT, SHALL BE LIMITED TO THE WARRANTY PERIOD SPECIFIED ABOVE. THE LIABILITY OF MAXLITE SHALL BE LIMITED TO THE TERMS OF THE EXPRESS WARRANTY SET FORTH HEREIN. IN NO EVENT WILL MAXLITE BE LIABLE FOR ANY SPECIAL, INCIDENTAL OR CONSEQUENTIAL DAMAGES INCLUDING, WITHOUT LIMITATION, DAMAGES RESULTING FROM LOSS OF USE, PROFITS, BUSINESS OR GOODWILL, LABOR COSTS, REMOVAL OR INSTALLATION COSTS, DECREASE IN THE LIGHT OUTPUT OF THE LAMP, AND/OR DETERIORATION IN THE LAMP'S PERFORMANCE, WHETHER OR NOT MAXLITE HAS BEEN ADVISED OF THE POSSIBILITY THEREOF. UNDER NO CIRCUMSTANCES SHALL MAXLITE'S ENTIRE LIABILITY FOR A DEFECTIVE PRODUCT EXCEED THE PURCHASE PRICE OF THAT PRODUCT. WARRANTY SERVICES PROVIDED UNDER THESE TERMS AND CONDITIONS DO NOT ENSURE THE UNINTERRUPTED OPERATION OF PRODUCTS; MAXLITE SHALL NOT BE LIABLE FOR DAMAGES CAUSED BY ANY DELAYS INVOLVING WARRANTY SERVICE.

This Limited Warranty gives you specific legal rights and you may also have other rights that may vary from state to state. Because some states or jurisdictions do not allow the exclusion or limitation of liability for consequential or incidental damages, this limitation may not apply to you.