

PXCYL CYLINDER INSTALLATION GUIDE - WARNING

WARNING – GREEN CREATIVE fixtures are designed to meet the latest NEC requirements. Check your local code requirements prior to installation.

WARNING – Fixture should be installed by a licensed electrician and must be installed in accordance with the NEC and all local building codes.

WARNING – Read all product labels and instructions before installing fixture.

WARNING – Wear safety gloves and other appropriate safety equipment.

4" and 6" SURFACE MOUNT INSTALLATION

Compatible with most standard octagonal 4" J-boxes with minimum height measuring 1.5". Not all existing J-boxes meeting these requirements will be compatible. A test installation should always be performed. J-box is provided by other.

1. Make sure the POWER IS TURNED OFF at the source to the J-box in which you are installing the product.
2. Attach 2 of the provided screws to the J-box screw holes. (fig. 1) Attach the mounting bracket to the J-box by inserting the pre-mounted screws through the key holes. Note the "TOP" marking on the bracket which should face toward the J-box (fig. 2). Rotate the bracket to secure it (fig. 3) and lock by fastening the screws (fig. 4).
3. Attach the safety clip to one of the holes in the mounting bracket, allowing fixture to hang securely. (fig. 5).
4. Wire to the power source (black to hot, white to neutral, green to ground) (fig. 6). For 0-10V dimming circuits, connect grey to grey and purple to purple. For EM and Sensor options, please follow the wiring diagram provided with those components.
5. Slide the blue Power switch to the desired setting (High, Medium or Low). Ensure the switch is not in between positions. (fig. 7) Make sure all wires are carefully tucked inside the J-box.
6. Align fixture's bracket slot with J-box bracket's insert tabs. Ensure the four tabs align with the four slots, the fixture should be flush with the ceiling and no wires should obstruct (fig. 8, 9 & 10). Rotate clockwise to secure the fixture with the bracket. (fig. 11 & 12)
7. Restore power at the source and installation is complete. (fig. 13)

fig. 1

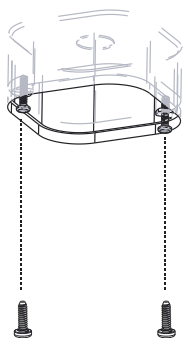

fig. 2

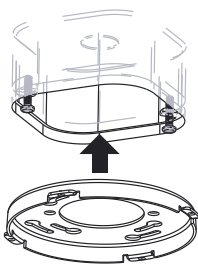

fig. 3

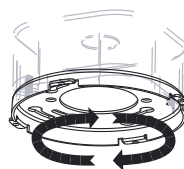

fig. 4

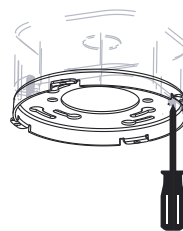

fig. 5

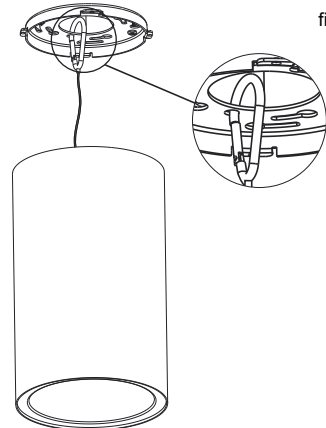

fig. 6

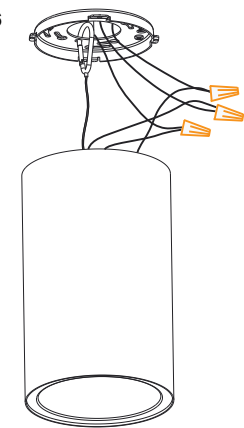

fig. 7

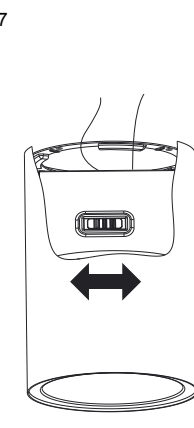

fig. 8

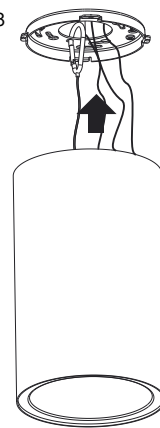

fig. 9

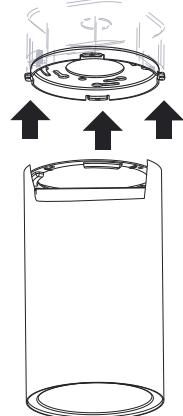

fig. 10

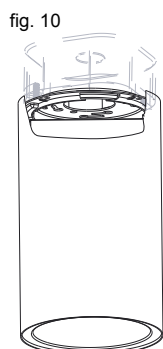

fig. 11

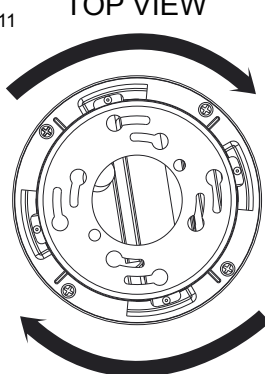

fig. 12

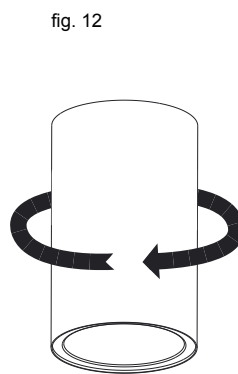
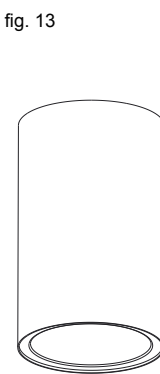

fig. 13



PXCYL CYLINDER INSTALLATION GUIDE - WARNING

WARNING – GREEN CREATIVE fixtures are designed to meet the latest NEC requirements. Check your local code requirements prior to installation.

WARNING – Fixture should be installed by a licensed electrician and must be installed in accordance with the NEC and all local building codes.

WARNING – Read all product labels and instructions before installing fixture.

WARNING – Wear safety gloves and other appropriate safety equipment.

8" SURFACE MOUNT INSTALLATION

Compatible with most standard octagonal 4" J-boxes with minimum height measuring 1.5". Not all existing J-boxes meeting these requirements will be compatible. A test installation should always be performed. J-box is provided by other.

1. Make sure the POWER IS TURNED OFF at the source to the J-box in which you are installing the product.
2. Attach 2 of the provided screws to the J-box screw holes. (fig. 1) Attach the mounting bracket to the J-box by inserting the pre-mounted screws through the key holes. Note the "TOP" marking on the bracket which should face toward the J-box (fig. 2). Rotate the bracket to secure it (fig. 3) and lock by fastening the screws (fig. 4).
3. Align the provided foam ring with the mounting bracket, use bracket tabs and foam ring notches to align properly (fig. 5). Stick the foam ring on the ceiling around the mounting bracket, the inner circle of the foam ring should be at the edge of the mounting bracket. (fig. 6).
4. Attach the safety clip to one of the holes in the mounting bracket, allowing fixture to hang securely. (fig. 7).
5. Wire to the power source (black to hot, white to neutral, green to ground) (fig. 8). For 0-10V dimming circuits, connect grey to grey and purple to purple. For EM and Sensor options, please follow the wiring diagram provided with those components.
6. Slide the blue Power switch to the desired setting (High, Medium or Low). Ensure the switch is not in between positions. (fig. 9) Make sure all wires are carefully tucked inside the J-box.
7. Align fixture's bracket slot with J-box bracket's insert tabs, use foam ring to align fixture body, edge of foam ring should be aligned with 8" Cylinder inner edge. Ensure the four tabs align with the four slots, the fixture should be flush with the ceiling and no wires should obstruct (fig. 10, 11 & 12). Rotate clockwise to secure the fixture with the bracket. (fig. 13 & 14)
8. Restore power at the source and installation is complete. (fig. 15)

fig. 1

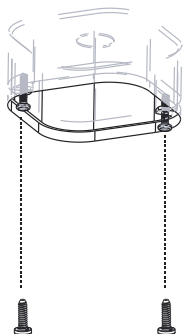

fig. 5

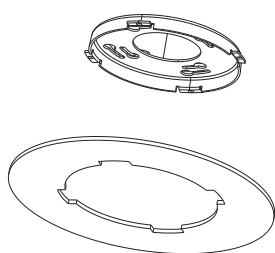

fig. 2

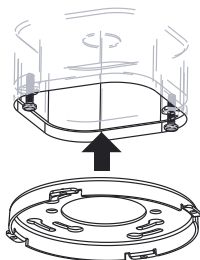

fig. 6

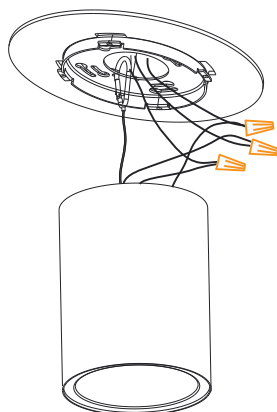

fig. 3

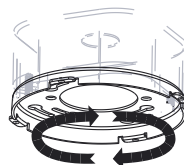

fig. 7

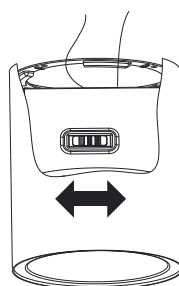

fig. 4

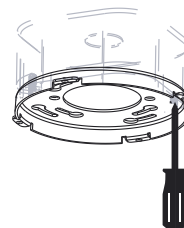

fig. 8

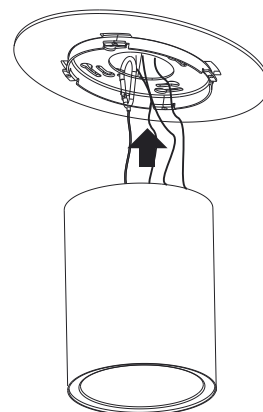

fig. 9

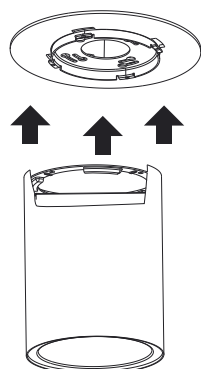

fig. 10

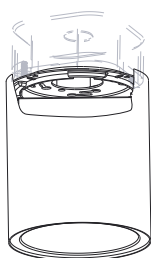

fig. 11

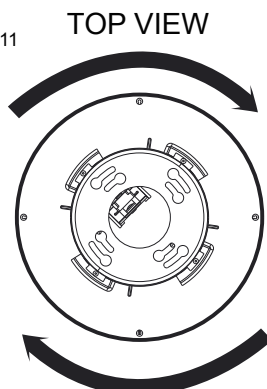

fig. 12

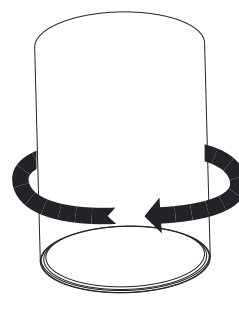
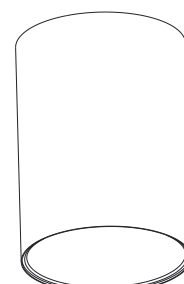

fig. 13



PENDANT STEM INSTALLATION

Compatible with most standard octagonal 4" J-boxes with minimum height measuring 1.5". Not all existing J-boxes meeting these requirements will be compatible. A test installation should always be performed. J-box is provided by other.

1. Make sure the POWER IS TURNED OFF at the source to the J-box in which you are installing the product.
2. To adjust the power, unscrew top cover of the Cylinder and slide the blue Power switch to the desired setting (High, Medium or Low). Ensure the switch is not in between positions. (fig. 1)
3. Connect the power cord to the driver, (black to hot, white to neutral, green to ground). For 0-10V dimming circuits, connect grey or pink to grey or pink and purple to purple. For EM and Sensor options, please follow the wiring diagram provided with those components. Carefully tuck all wires and connectors in the cylinder driver compartment and pass the cord through the stem holder. (fig. 2)
4. Place back top cover and screw back once power cord has been properly connected to the driver. (fig. 3)
5. Pass the cord through the stem and screw it into the fixture's stem holder. (fig. 4)
6. Insert the canopy cover over cord and stem. (fig. 5)
7. Screw the half ball at the top of the stem. (fig. 6) Ensure the stem, stem adapter and swivel are all firmly attached and tighten together.
8. Attach the swivel retaining bracket to the J-box with provided screws. (fig. 7)
9. Hang the fixture's half ball to the swivel retaining bracket (fig. 8). Wire to the power source (black to hot, white to neutral, green to ground) (fig. 9). For 0-10V dimming circuits, connect grey or pink to grey or pink and purple to purple. For EM and Sensor options, please follow the wiring diagram provided with those components. Carefully tuck all wires and connectors in the J-box.
10. Slide canopy cover up over the stem and clip the notches to the retaining bracket side clips. (fig. 10) Ensure the canopy is correctly fastened and both bracket clips are correctly inserted in the canopy notches.
11. Restore power at the source and installation is complete.

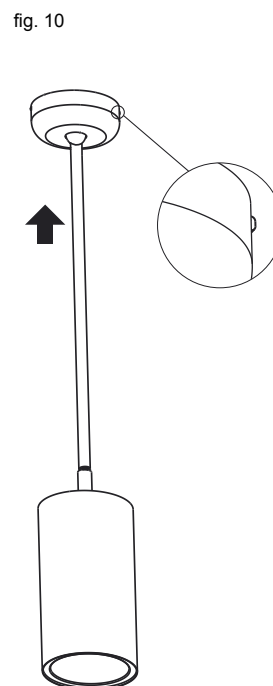
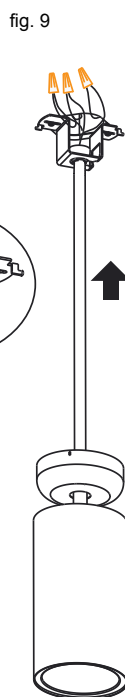
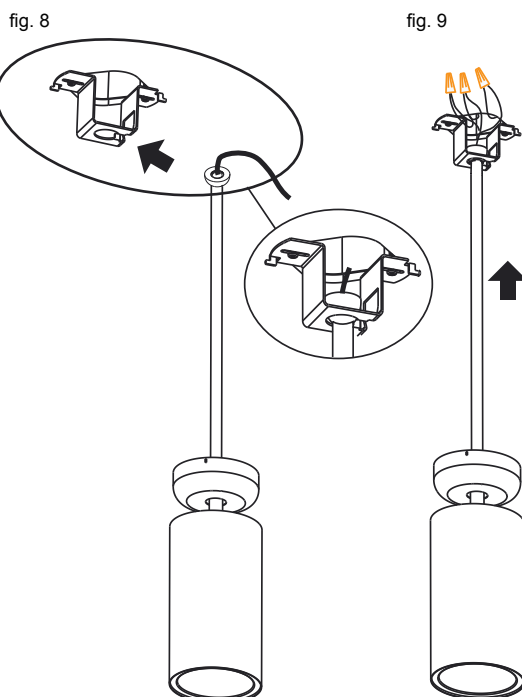
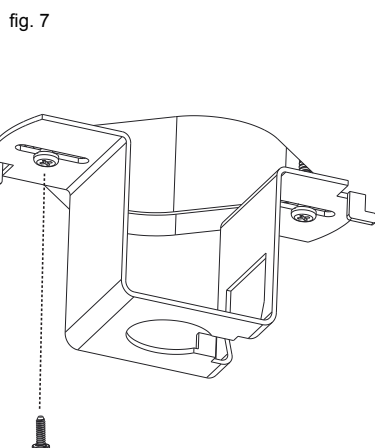
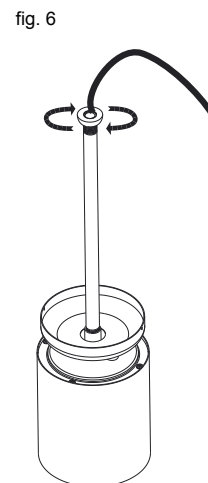
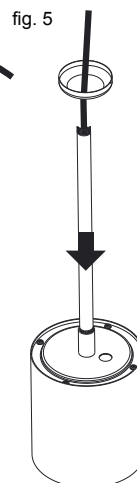
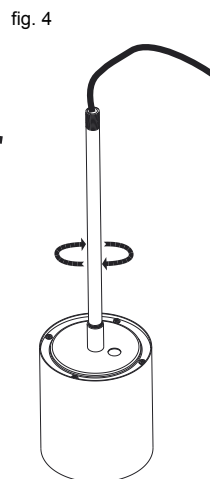
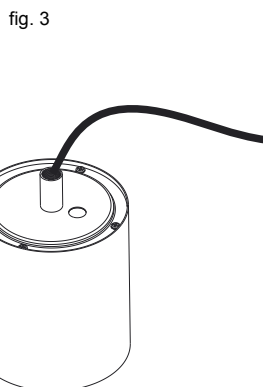
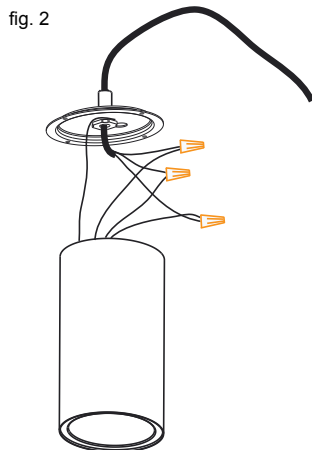
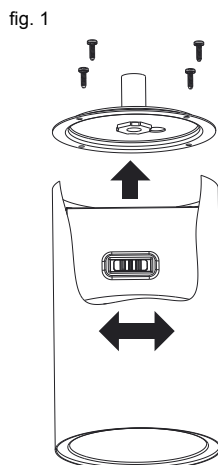

SUSPENSION CABLE INSTALLATION

Compatible with most standard octagonal 4" J-boxes with minimum height measuring 1.5". Not all existing J-boxes meeting these requirements will be compatible. A test installation should always be performed. J-box is provided by other.

1. Make sure the POWER IS TURNED OFF at the source to the J-box in which you are installing the product.
2. To adjust the power, unscrew top cover of the Cylinder and slide the blue Power switch to the desired setting (High, Medium or Low). Ensure the switch is not in between positions. (fig. 1)
3. Connect the power cord to the driver, (black to hot, white to neutral, green to ground). For 0-10V dimming circuits, connect grey or pink to grey or pink and purple to purple. For EM and Sensor options, please follow the wiring diagram provided with those components. Adjust cable and cord to the desired length. Carefully tuck all wires and connectors in the cylinder driver compartment. Place back top cover and screw back once power cord has been properly connected to the driver. (fig. 2)
5. Attach the cross-bar bracket to the J-box with provided screws. (fig. 3)
6. Attach the cable to the cross-bar bracket, by screwing the cable coupler to the cross-bar stud. (fig. 4 & 5)
7. Wire to the power source (black to hot, white to neutral, green to ground) (fig. 6). For 0-10V dimming circuits, connect grey or pink to grey or pink and purple to purple. For EM and Sensor options, please follow the wiring diagram provided with those components. Carefully tuck all wires and connectors in the J-box.
8. Slide canopy cover up and secure it by screwing the coupler to cable coupler. (fig. 7)
9. Restore power at the source and installation is complete (fig. 8)

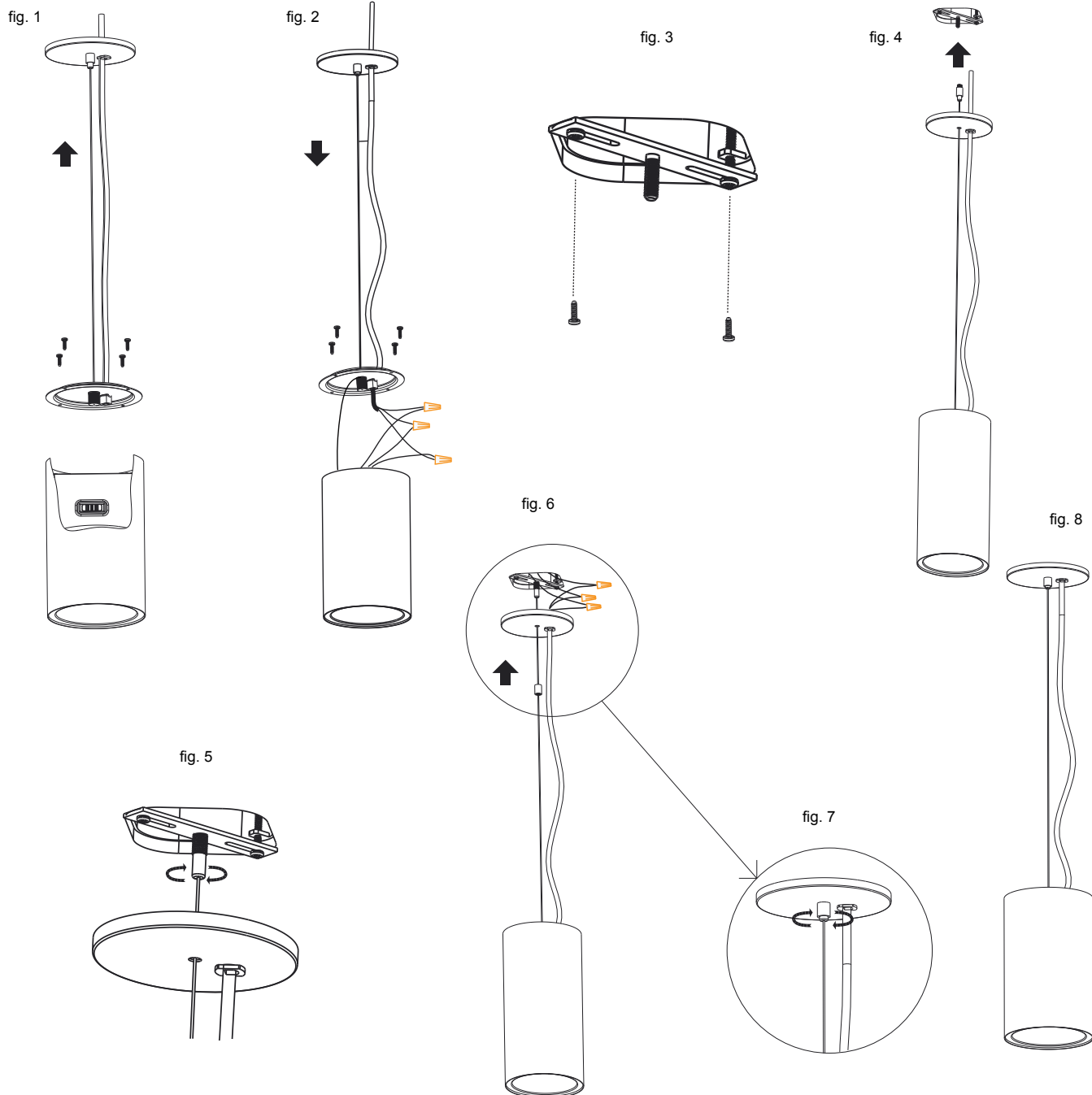

CONDUIT CANOPY PENDANT STEM INSTALLATION

Compatible with most standard octagonal 4" J-boxes with minimum height measuring 1.5". Not all existing J-boxes meeting these requirements will be compatible. A test installation should always be performed. J-box is provided by other.

1. Make sure the POWER IS TURNED OFF at the source to the J-box in which you are installing the product.
2. To adjust the power, unscrew top cover of the Cylinder and slide the blue Power switch to the desired setting (High, Medium or Low). Ensure the switch is not in between positions. (fig. 1)
3. Connect the power cord to the driver, (black to hot, white to neutral, green to ground). For 0-10V dimming circuits, connect grey or pink to grey or pink and purple to purple. For EM and Sensor options, please follow the wiring diagram provided with those components. Carefully tuck all wires and connectors in the cylinder driver compartment and pass the cord through the stem holder. (fig. 2)
4. Place back top cover and screw back once power cord has been properly connected to the driver. (fig. 5)
5. Pass the cord through the stem and screw it into the fixture's stem holder. (fig. 4)
6. Insert Conduit Canopy over cord and stem. (fig. 4)
7. Screw the swivel half ball at the top of the stem. (fig. 6) Ensure the stem, stem adapter and swivel are all firmly attached and tighten together. (fig. 7)
8. Place the Cylinder on a stepladder or any flat surface, at close distance of your junction box, so you can make your wiring securely. Wire to the power source (black to hot, white to neutral, green to ground) (fig. 8). For 0-10V dimming circuits, connect grey to grey and purple to purple. For EM and Sensor options, please follow the wiring diagram provided with those components. Carefully tuck all wires and connectors in the J-box. (fig. 8)
9. Slide canopy cover up over the stem and place the Canopy Cover Mounting screws. (fig. 9) Tighten the 2 screws until the canopy conduit cover is flush with the J-box. (fig. 10)
10. Restore power at the source and installation is complete, (fig. 11)

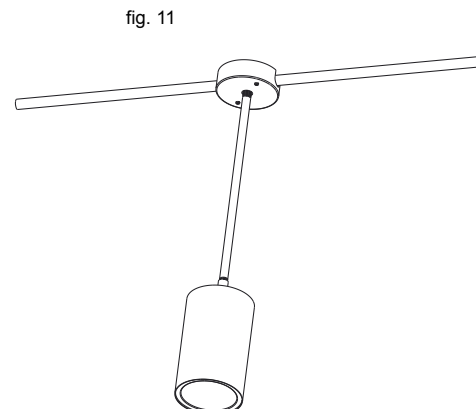
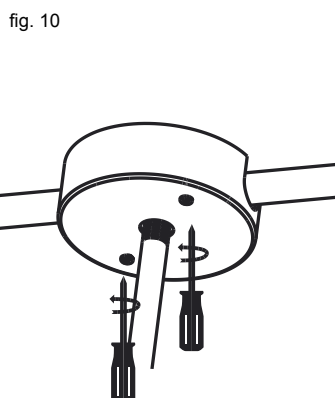
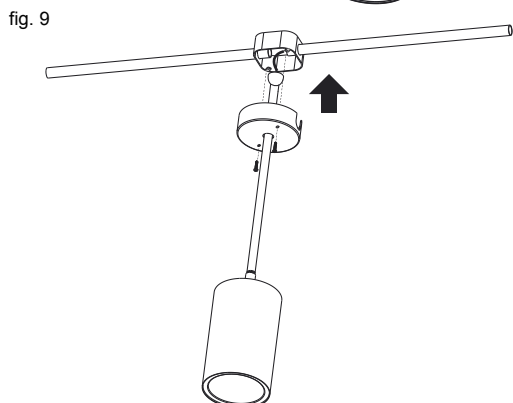
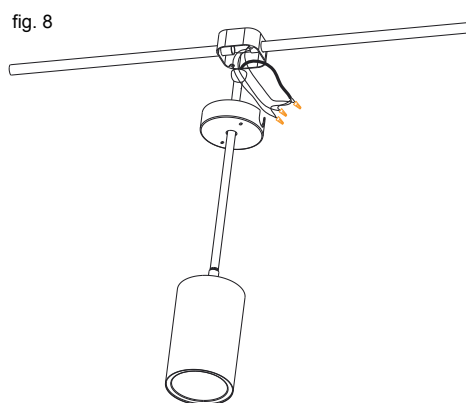
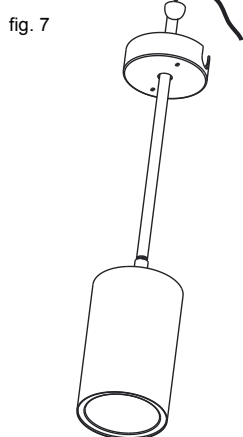
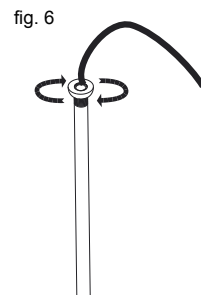
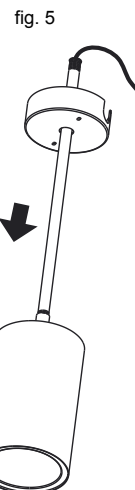
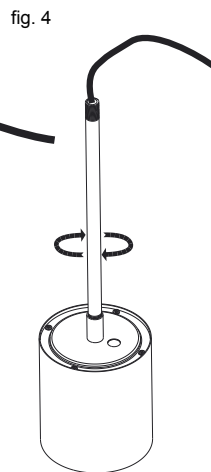
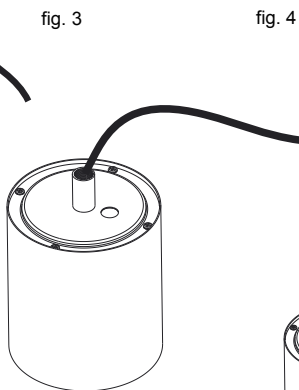
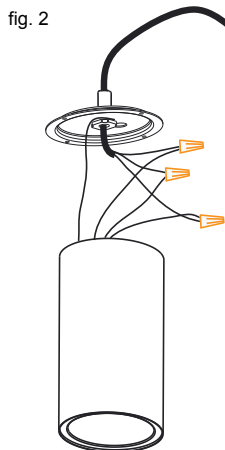
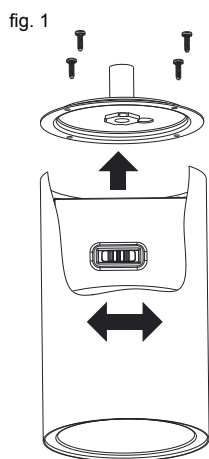

WALL MOUNT INSTALLATION

Compatible with most standard octagonal and square 4" J-boxes with minimum depth of 1.5". Not all existing J-boxes meeting these requirements will be compatible. A test installation should always be performed. J-box is provided by other.

1. Make sure the POWER IS TURNED OFF at the source to the J-box in which you are installing the product.
2. To adjust the power, unscrew top cover of the Cylinder and slide the blue Power switch to the desired setting (High, Medium or Low). Ensure the switch is not in between positions. Place back top cover and screw back once desired output has been selected. (fig. 1 & 2)
3. Attached the wall bracket to the J-box with provided screws. The flat part should be directed toward the wall. Note the Up and ↑ marking and orient the bracket accordingly. (fig. 2)
4. Hang the fixture on the bottom hook of the J-box bracket, with the pre-set screw on the wall mount fixture's cover plate. This pre-set screw is always placed at the top of the cover plate for both up light and downlight applications. This screw doesn't need to be tightened more during the installation. (fig 3)
5. While fixture is hanging, wire to the power source (black to hot, white to neutral, green to ground) (fig. 4). For 0-10V dimming circuits, connect grey to grey and purple to purple. For EM and Sensor options, please follow the wiring diagram provided with those components. Carefully tuck all wires and connectors in the J-box.
6. Detach the fixture and hang it with the top pre-set screw at the top hook of J-box bracket. (fig. 5) Push the fixture toward the wall and place the cover plate over the bracket. (fig. 6) Fixture should be flush with the wall. (fig. 7)
7. Tighten the bottom set-screw. Once flush with the cover plate edge, the fixture is secure. Overtightening will cause the set-screw to strip out and fail. (fig. 8)
8. Restore power at the source and installation is complete.

fig. 1

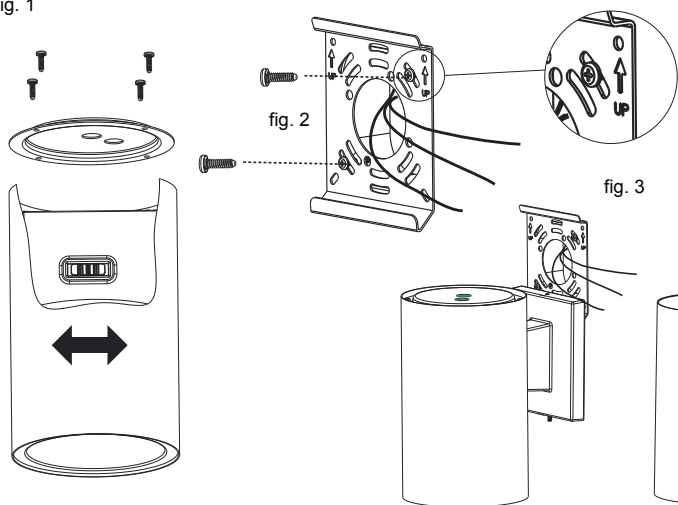

fig. 2

fig. 3

fig. 4

Down lighting

Up lighting

Down lighting

Up lighting

fig. 5

fig. 6

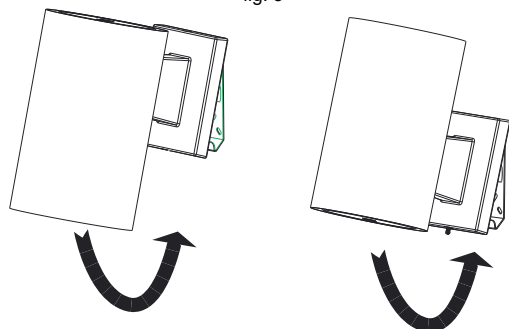

Down lighting

Up lighting

fig. 7

fig. 8

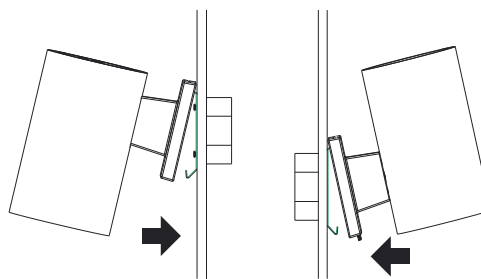

Down lighting

Up lighting

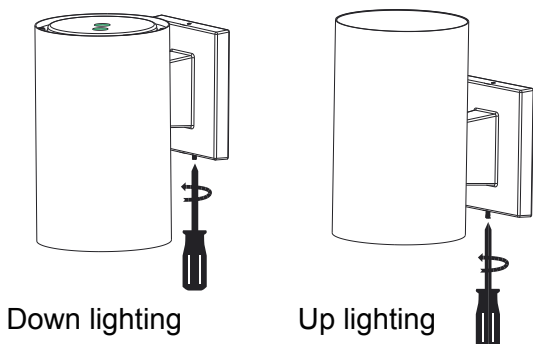

Down lighting

Up lighting

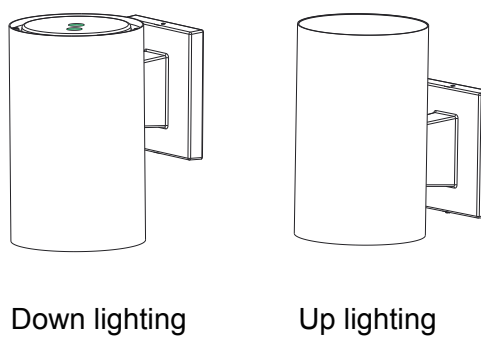

Down lighting

Up lighting

WET LOCATION INSTALLATION FOR SURFACE AND WALL MOUNT DOWN LIGHTING

WARNING – Wet location installation should be performed with Cylinders with WET location option for surface mounting and wall mounting in down lighting position only

WARNING – Wet location installation should be performed under covered ceiling where the fixture is not directly exposed to weather

WARNING – Wet location installation for Wall Mounting is not suitable for up lighting application

For surface mount installation:

Once product is properly installed, to ensure full wet location protection, apply silicone caulk around the perimeter of the Cylinder at the junction with the ceiling. (fig. 1)

For Wall Mount installation (downlight direction only):

After you've made your power selection on the driver (for SelectDrive Drivers), to ensure full wet location protection, seal the top cover by applying silicon caulk all around at the rim of the top cover and cylinder body edge. (fig. 2)

Once product is properly installed, to ensure full wet location protection, apply silicone caulk around the perimeter of the Cylinder Wall Mounting base at the junction with the wall and on the screw holes. (fig. 3)

fig. 1

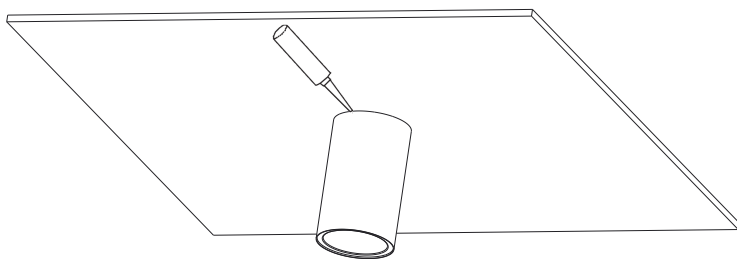

fig. 3

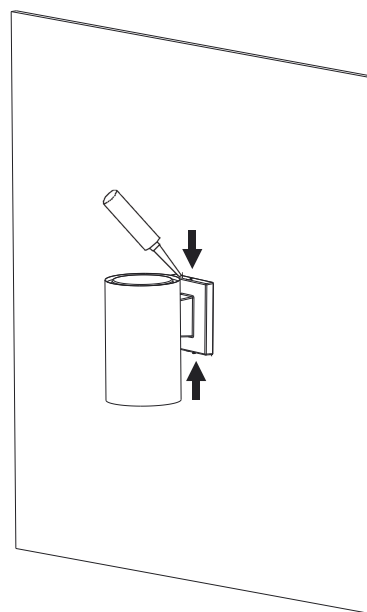

fig. 2

