

5-6" DOWNLIGHT RETROFIT 5 CCT SELECTABLE LR23043

IMPORTANT

READ CAREFULLY BEFORE INSTALLING FIXTURE. KEEP THESE INSTRUCTIONS FOR FUTURE REFERENCE.

WARNINGS

- **RISK OF ELECTRIC SHOCK** - DISCONNECT POWER AT FUSE OR CIRCUIT BREAKER BEFORE INSTALLING OR SERVICING.
- TO PREVENT EARLY LAMP FAILURE, LAMP SHOULD ONLY BE INSTALLED IN OPERATING ENVIRONMENTS RANGING BETWEEN -20° C AND + 40° C (-4° F AND 104° F)
- NO USER SERVICEABLE PARTS INSIDE, TO AVOID ELECTRICAL SHOCK DO NOT DISASSEMBLE PRODUCT.
- **RISK OF FIRE OR ELECTRIC SHOCK** - LED RETROFIT KIT INSTALLATION REQUIRES KNOWLEDGE OF LUMINAIRE ELECTRICAL SYSTEMS. IF NOT QUALIFIED, DO NOT ATTEMPT INSTALLATION. CONTACT A QUALIFIED ELECTRICIAN.
- **RISK OF FIRE OR ELECTRIC SHOCK** - INSTALL THIS KIT ONLY IN LUMINAIRE THAT HAVE THE CONSTRUCTION FEATURES AND MIN DIMENSIONS SHOWN ON FIGURE 1, AND WHERE THE INPUT RATING OF THE RETROFIT KIT DOES NOT EXCEED THE INPUT RATING OF THE LUMINAIRE.
- **DO NOT MAKE OR ALTER ANY OPEN HOLES IN AN ENCLASURE OF WIRING OR ELECTRICAL COMPONENTS DURING KIT INSTALLATION.**
- TO PREVENT WIRING DAMAGE OR ABRASION, DO NOT EXPOSE WIRING TO EDGES OF SHEET METAL OR OTHER SHARP OBJECTS.
- INSTALLERS SHOULD NOT DISCONNECT EXISTING WIRES FROM LAMPHOLDER TERMINALS TO MAKE NEW CONNECTIONS AT LAMPHOLDER TERMINALS, INSTEAD, INSTALLERS SHOULD CUT EXISTING LAMPHOLDER LEADS AWAY FROM THE LAMPHOLDER AND MAKE NEW ELECTRICAL CONNECTIONS TO LAMPHOLDER LEAD WIRES BY EMPLOYING APPLICABLE CONNECTORS.
- **THIS RETROFIT KIT IS ACCEPTED AS A COMPONENT OF A LUMINAIRE WHERE THE SUSTAINABILITY OF THE COMBINATION SHALL BE DETERMINED BY AUTHORITIES HAVING JURISDICTION.**
- **THIS DEVICE IS NOT INTENDED FOR USE WITH EMERGENCY EXITS.**
- THIS RETROFIT KITS SUITABLE FOR WET LOCATIONS LUMINAIRE SPECIFIED AS BELOW: TYPE NON IC; TYPE IC; COVERED CEILING; UNCOVERED CEILING.

FIGURE 1. MIN. LUMINAIRE DIMENSION

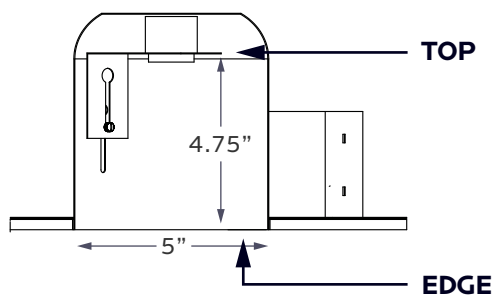

INSTALLATION INSTRUCTIONS

1. MAKE SURE THE POWER IS TURNED OFF AT THE SOURCE TO THE RECESSED HOUSING (S) THAT YOU ARE INSTALLING THE FIXTURE(S) IN. REMOVE EXISTING TRIM AND CFL, OR INCANDESCENT BULBS.

2a. UNSCREW THE SCREWS ON SOCKET BRACKET, PUSH BRACKET UPWARD TO THE TOP LOCATION. FIGURE 2a

2b. REMOVE EXISTING SOCKET MOUNTING PLATE FROM THE RECESSED HOUSING AND THEN REMOVE LAMP SOCKET FROM THE PLATE. FIGURE 2b

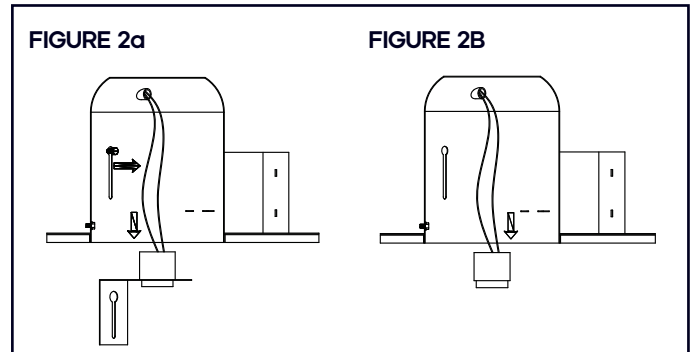

3. SCREW E26 BASE ADAPTER INTO SOCKET IN RECESSED HOUSING. FIGURE 3

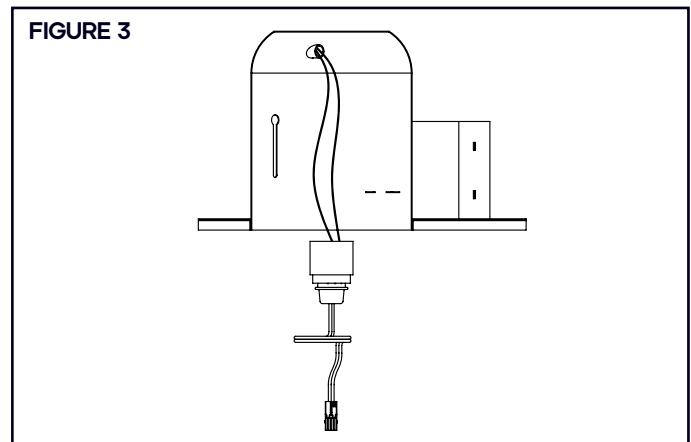

4. SELECT DESIRED CCT FIGURE 4

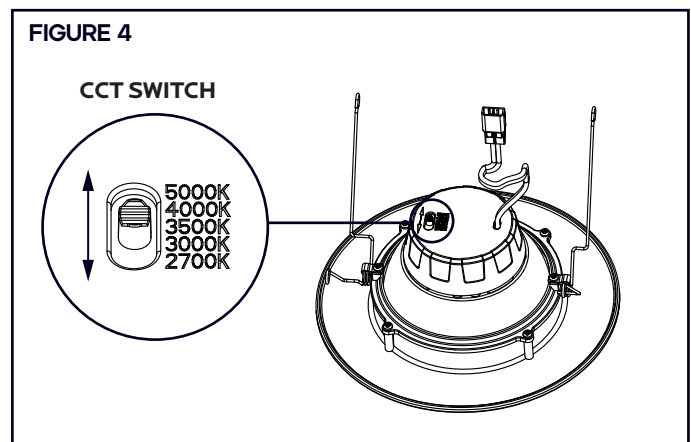

5. PLUG E26 BASE CABLE CONNECTOR INTO THE LED RECESSED KIT. MAKE SURE THE KIT IS GROUNDED. **FIGURE 5**

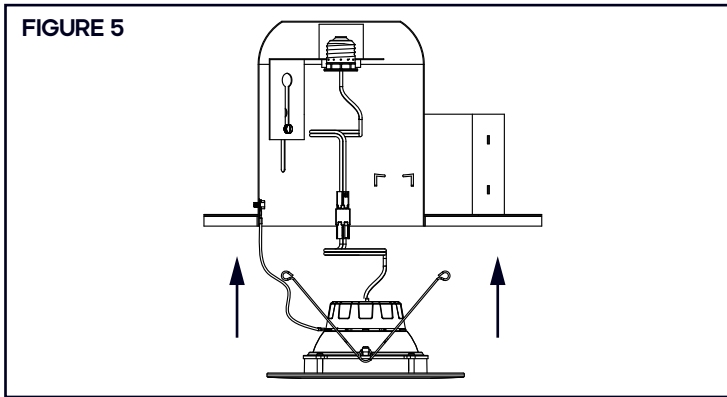

6 . SQUEEZE TORSION SPRINGS TOGETHER AS SHOWN AND INSTALL INTO TORSION SPRING BRACKETS INSIDE RECESSED HOUSING. FOR PROPER INSTALLATION, THE TORSION SPRINGS SHOULD BE SEATED WITHIN THE BRACKETS AND ON BOTH SIDES OF THE HOUSING. **FIGURE 6**

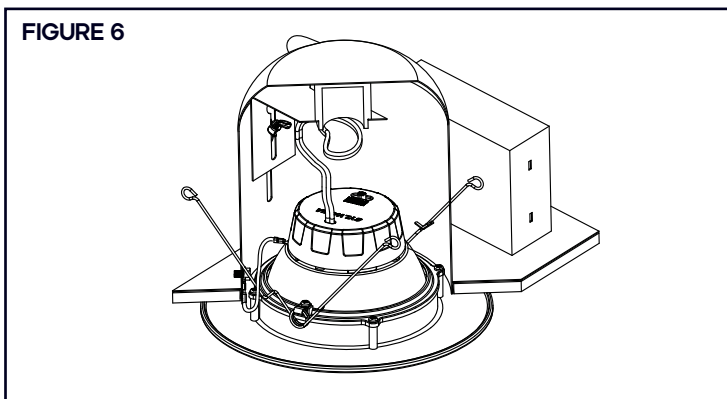

7 . CAREFULLY ROUTE WIRES INTO FIXTURE AND PUSH RECESSED KIT UP FLUSH TO CEILING SURFACE. PUSH THE EDGE OF THE BEZEL TO TILT LENS UP TO 30°. ROTATE LENS ASSEMBLY HORIZONTALLY TOWARDS THE SURFACE TO BE ILLUMINATED. **FIGURE 7**

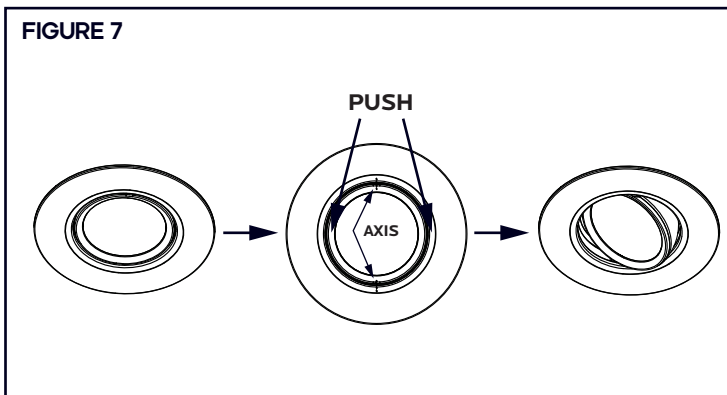

DIMENSIONS

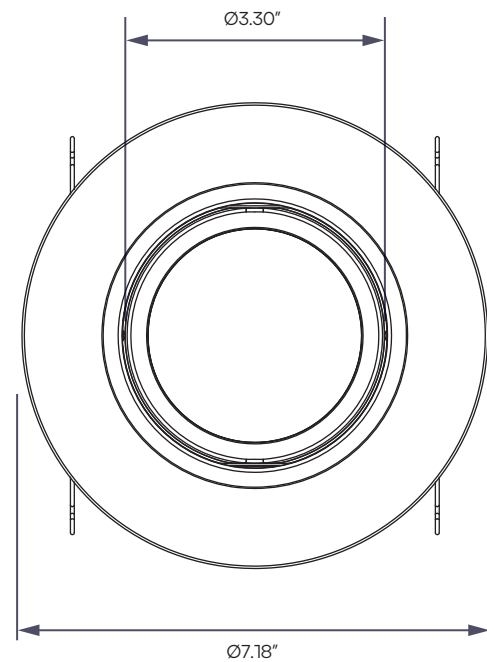
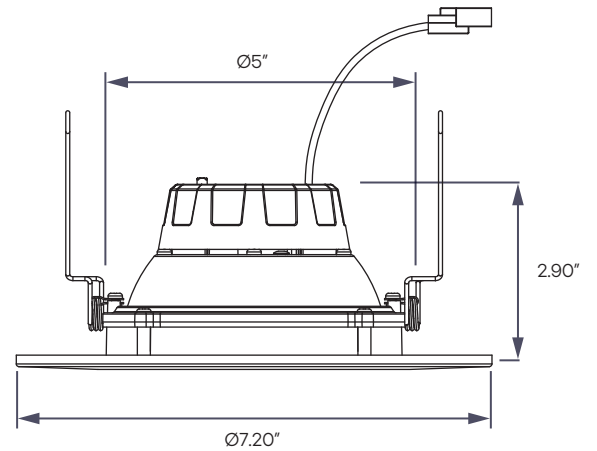

5-6"