

NU6

6" Round Downlight RGBW

AT
airtightDF
dead-frontPR
plenum rated

wet rated

CASAMBI

PROJECT INFORMATION		
JOB NAME		TYPE
ORDERING CODE		

30° -65° BEAM

(Note: Specifications are subject to change without notice)

14mm COB PERFORMANCE DATA

LED LIGHT ENGINE	NOMINAL DELIVERED LUMENS	SYSTEM WATTAGE
10LM	1090LM @30K/90CRI	25W
Notes	Delivered lumens based on HE60 80CRI 3000K (see page 3)	

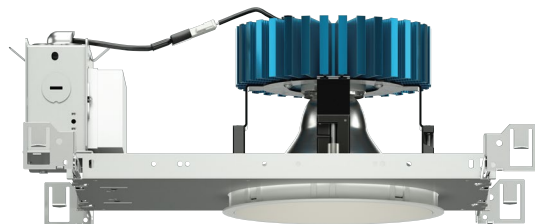

Trim

FEATURES

- RGB (W) five white CCT options available.
- On-board, closed-loop optical feedback measures the lumen depreciation of each channel and re-balances the color model to ensure color consistency over the life of LED array.
- 40° - 80° optical beam control
- Multiple mounting, trims and finishes available

DIMMING AND CONTROLS

- Multiple mounting, trims and finishes available
- BLE mesh network control, profile allows color mixing on Casambi app

CONSTRUCTION

- Shatter proof acrylic bezel lens
- Lexan™ (PC) Optimal connectivity for wireless control signal
- Impact and chemical resistant at the highest level
- Withstands temperatures up to 240°F
- Electrocoated 16-gauge cold rolled steel construction
- Accommodates ceiling thickness from 1/8" to 2"

LED

- Lumiled LUXEON C Color Line
- SDCM = 2-step MacAdam Ellipse, Duv +/- 0.002, Lumen Maintenance: $L_{70} > 50,000$ hrs

LISTING

- ULus Listed to UL1598 & UL2108; cUL Listed to CSA C22.2 #250.0
- IP65 with lens - Suitable for wet locations with lens - Suitable for damp location without lens.
- Non-conductive, dead-front construction (shower approved)
- Made in the USA - meets the requirements of the Buy American provision within the ARRA
- NSF/ANSI-2 with lens (Non-Food and Splash Zones)
- 5 Year Limited warranty

ELECTRICAL

- 120-277VAC 50/60Hz input
- Power factor > 0.9
- Max ambient temperature 50oC
- Battery Backup not offered. Emergency Generator/Inverter/ Controls-Override Device supplied by others.

FIXTURE HEIGHT

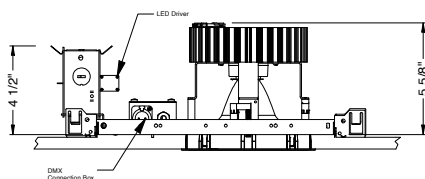

TRIMMED

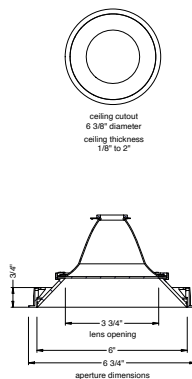

40°- 75° BEAM ORDERING CODE		
SERIES	NU6	NU6
TYPE	RD	round downlight
LED	RGBW	red, green, blue, white
DELIVERED LUMENS	10LM	760 lm
	Calculated Delivered Lumens = [Delivered Lumen Value] x [CCT Multiplier] x [Reflector Multiplier]	
CCT	30K	RGBW with white at 3000K
	27K	RGBW with white at 2700K
	35K	RGBW with white at 3500K
	65K	RGBW with white at 6500K
	43K	RGBW with white at 4300K
CRI	90	90 CRI
OPTIC & LM MULTIPLIER SEE PAGE 3	HE40	40° high efficiency diffused lens
	HE60	60° high efficiency diffused lens
	HE80	80° high efficiency diffused lens
	SS40	40° semi-specular with clear lens
	SS50	50° semi-specular with clear lens
	SS60	60° semi-specular with clear lens
	D40	40° diffused with clear lens
	D60	60° diffused with clear lens
TRIM COLOR SEE PAGE 3	WH70	70° brilliant white with clear lens
	BK	black
	WH	white
	MC	matte chrome
	WT	wheat
BEZEL COLOR SEE PAGE 3	BZ	bronze
	BK	black (0.98)
	WH	white (1.00)
	MC	matte chrome (0.99)
	BZ	bronze (0.98)
	WT	wheat (0.99)

PROJECT INFORMATION			
JOB NAME		TYPE	
ORDERING CODE			

40°- 75° BEAM ORDERING CODE		
MOUNTING OPTIONS SEE PAGE 6, 7	NC	new construction with ceiling fitting plate
	IC	insulation contact housing
	ICAT	insulation contact/airtight housing
	CP	chicago plenum housing
	RET	retrofit, no ceiling fitting plate
VOLTAGE	120	120V
	277	277V
DIMMING	DMX-RJ45	DMX control dimming to 0.1% with RJ45 connection box
	DMX-WL	DMX control dimming to 0.1% with wire lead connection box
	DMX-XLR	DMX control dimming to 0.1% with XLR 5pin connection box
	CAS	Casambi Bluetooth control with flicker free 1% dimming

ADDITIONAL MOUNTING INFO	
New Construction Bar Hangers (included)	Mounting Length: 14-3/4" to 26"
Extension Kit p/n: K20266 (ordered separately, 1 per fixture)	<i>Extends a pair of Bar Hangers</i> Total Mounting Length: 29" to 48"

YOUR COMPLETED ORDERING CODE
Follow the steps to specify your fixture, example:
NU6 - RD - RGBW - 10LM - 35K - 90 - SS40 - WH - NC - UNV - DIM10

PROJECT INFORMATION			
JOB NAME		TYPE	
ORDERING CODE			

TRIM OPTIONS

TRIM/BEZEL COLORS

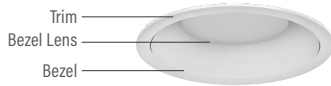

WH



MC



BK



BZ



WT

OPTICAL OPTIONS

- UGR calculation based on CIE 117-1995; room size: 4H X 8H, reflectance: 70/50/20;
- UGR calculation based on 15LM fixtures.

NL
No Lens



OPTIC	BEAM ANGLE	UGR
SS40	41.1	12.4
SS50	46	13.7
SS60	58.3	14.4
D40	38.6	13
D60	62.6	15.6
WH70	73.6	18.5

DL
Diffused Lens



OPTIC	BEAM ANGLE	UGR
HE40	44.2	16.4
HE60	63.9	18.6
HE80	79	20.5

GLARE CONTROL

CUT-OFF ANGLE

Visual comfort is achieved with a lower cut-off angle due to improved glare control. The smaller the cut-off angle, the easier it is on the eye.

Alphabet downlights have been thoughtfully engineered to eliminate glare while still delivering functional illumination.

- Cutoff angle of NL and DL is 36.5 degrees;

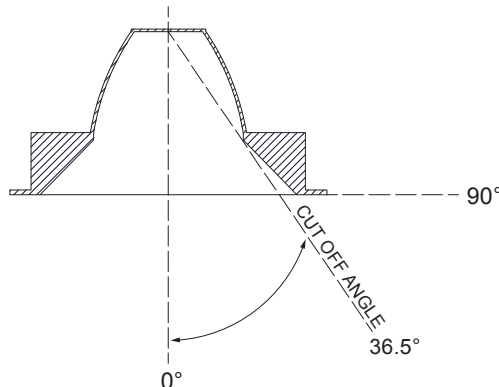

PROJECT INFORMATION			
JOB NAME		TYPE	
ORDERING CODE			

PHOTOMETRIC DATA

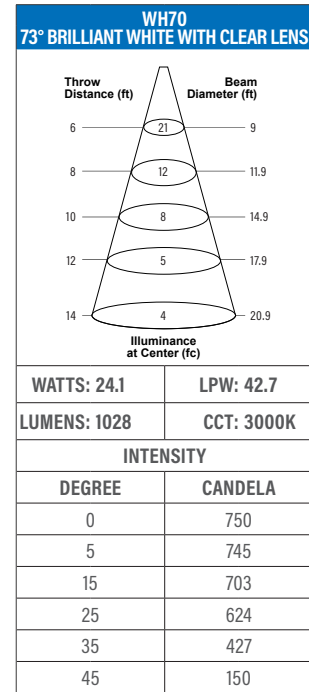
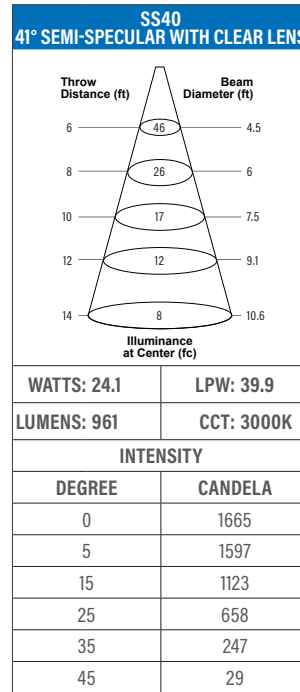
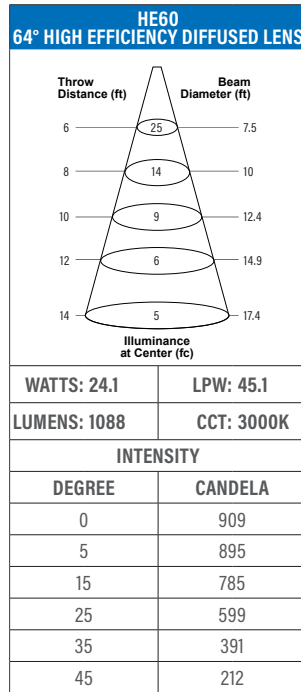
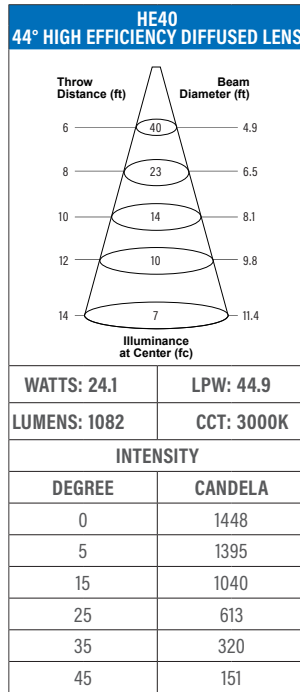

PROJECT INFORMATION			
JOB NAME		TYPE	
ORDERING CODE			

RGB SPECTRAL PLOT

DOMINANT WAVELENGTH	
	MEASURED
R	623.9
G	524.2
B	461.9

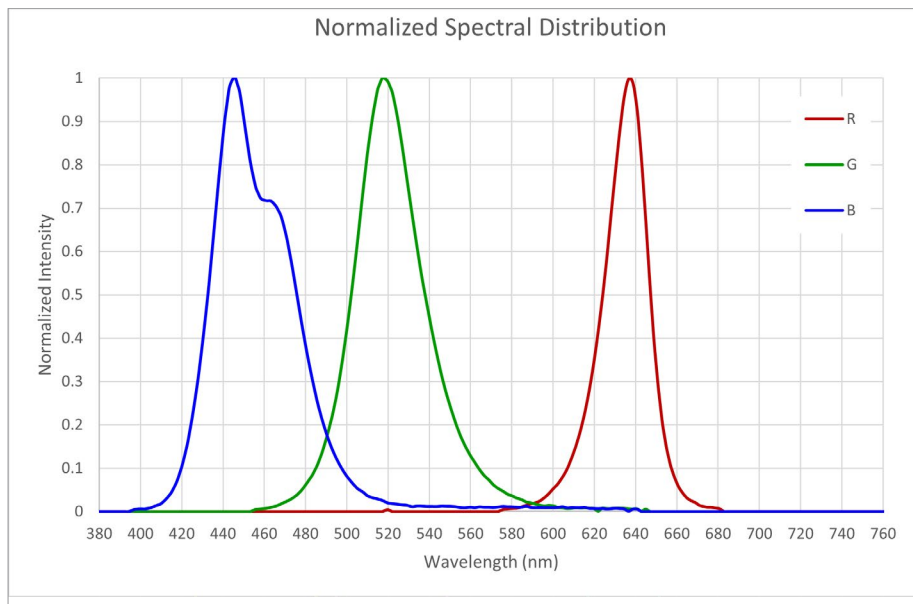

COLOR GAMUT PLOT

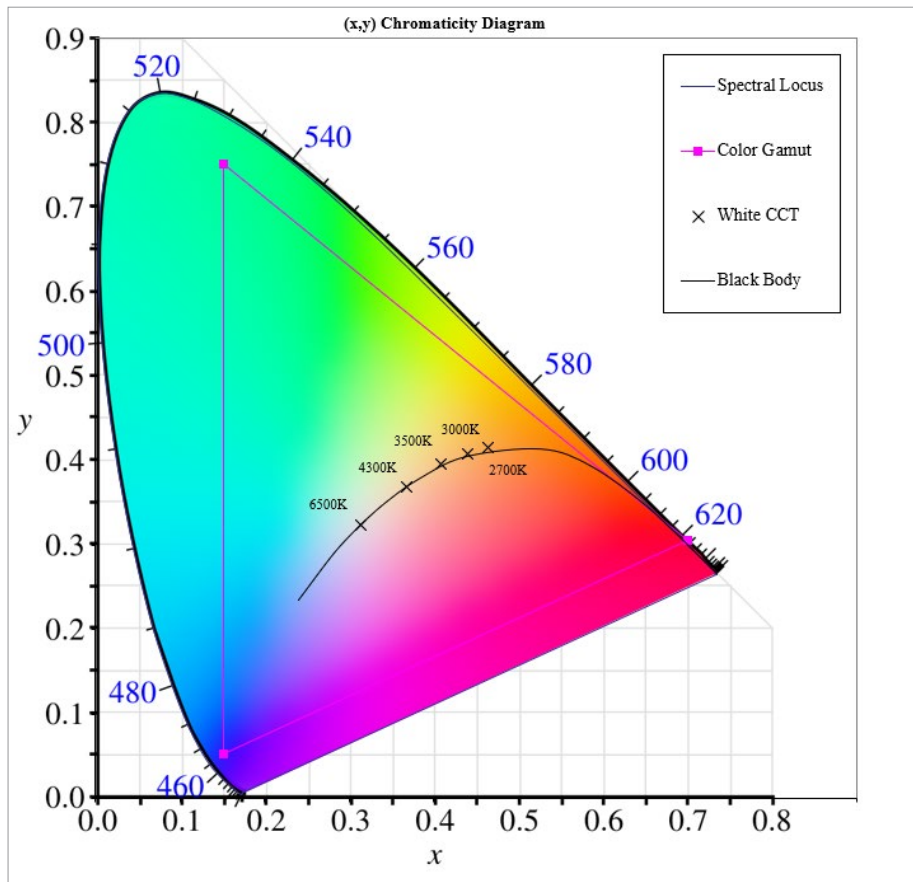

PROJECT INFORMATION			
JOB NAME		TYPE	
ORDERING CODE			

MOUNTING OPTIONS

FIXTURE HEIGHT

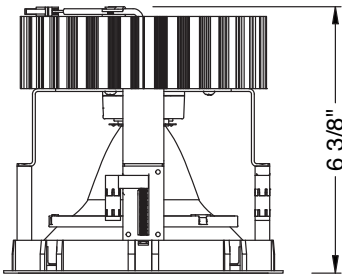

TRIMMED

NC - NEW CONSTRUCTION

TRIM

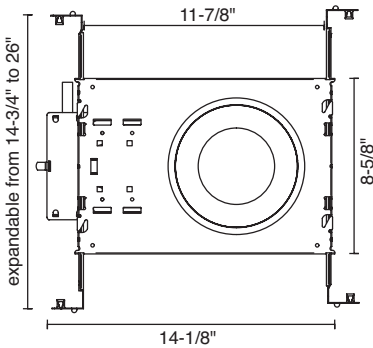
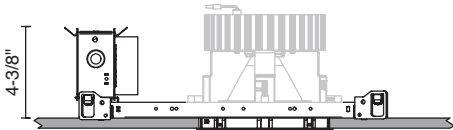

TRIMMED (STANDARD)

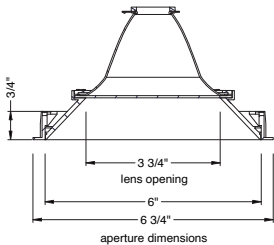
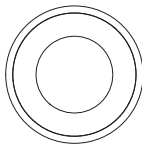

PROJECT INFORMATION			
JOB NAME		TYPE	
ORDERING CODE			

MOUNTING OPTIONS (CONTINUED)

RET - RETRO TRIM/TRIMLESS

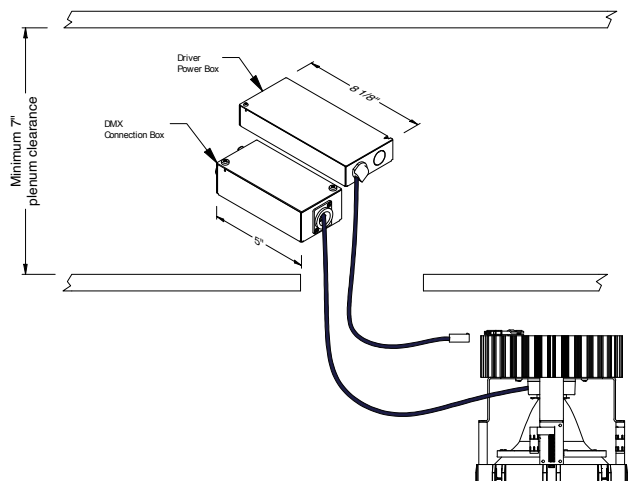

RATINGS / CERTIFICATIONS	NC	RET	IC	ICAT	CP
TYPE NON-IC	✓	✓			
TYPE IC			✓	✓	✓
CHICAGO PLENUM (CCEA)					✓
SUITABLE FOR AIR HANDLING PLENUMS	✓	✓	✓	✓	✓
REDUCED AIRFLOW (WITH LENS) ASTM E283	✓	✓	✓	✓	✓

CEILING THICKNESS	
FIXTURE TYPE	MOUNTING TYPE
	NC, IC, ICAT, CP, RET
	STANDARD CEILING THICKNESS
TRIM	1/8" to 2"

IC - INSULATION CONTACT HOUSING

ICAT - INSULATION CONTACT / AIR TIGHT

CP - CHICAGO PLENUM

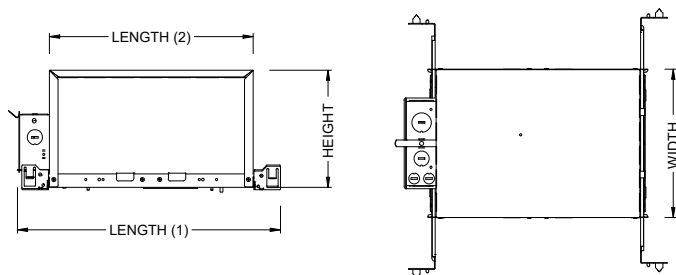

BOX SIZE	L 1	L 2	W	H
A	18 - 1/4"	14 - 7/8"	12 - 1/8"	8 - 1/2"

BOX TYPE / LUMEN OUTPUT - STANDARD BEAMS (40° - 75°)			
LUMEN OUTPUT	BOX - A		
	CP	IC	ICAT
10LM	✓	✓	✓