

Commercial Downlight with Integral Emergency Battery Backup Installation Instructions



For Halco Products: CDLEM-xx-LS-CS-xx-DDV

IMPORTANT

READ CAREFULLY BEFORE INSTALLING FIXTURE. RETAIN THESE INSTRUCTIONS FOR FUTURE REFERENCE.

WARNINGS:

- Risk of electrical shock. Disconnect power at fuse or circuit breaker before installing or servicing.
- To prevent early lamp failure, lamp should only be installed in operating environments ranging between -20°C and 40°C (-4°F and 104°F).
- No user-serviceable parts inside. To avoid electrical shock, do not disassemble product.
- Risk of fire or electric shock. Installation requires knowledge of luminaire electrical systems. If not qualified, do not attempt installation. Contact a qualified electrician.
- Risk of fire or electric shock. Install this kit only in luminaires that have the construction features and minimum dimensions shown in these instructions and where the input rating of the retrofit kit does not exceed the input rating of the luminaire.
- Do not make or alter any open holes in an enclosure of wiring or electrical components during kit installation
- To prevent wiring damage or abrasion, do not expose wiring to edges of sheet metal or other sharp objects.
- Installers should not disconnect existing wires from lampholder terminals to make new connections at lampholder terminals. Instead, installers should cut existing lampholder leads away from the lampholder and make new electrical connections to lampholder lead wires by employing applicable connectors.
- The retrofit kit is accepted as a component of a luminaire where the suitability of the combination shall be determined by authorities having jurisdiction. Product must be installed by a qualified electrician in accordance with the applicable and appropriate electrical codes. The installation guide does not supersede local or national regulations for electrical installations.
- This device is not intended for use with emergency exits.
- Caution - risk of fire. Consult a qualified electrician to ensure correct branch circuit conductor.
- Minimum 90°C supply conductors
- Installers should examine all parts that are not intended to be replaced by the retrofit kit for damage and replace any damaged parts prior to installation of the retrofit kit.

This equipment has been tested and found to comply with the limits for a Class A digital device, pursuant to Part 15 of the FCC Rules. These limits are designed to provide reasonable protection against harmful interference when the equipment is operated in a commercial environment. This equipment generates, uses, and can radiate radio frequency energy and, if not installed and used in accordance with the instruction manual, may cause harmful interference to radio communications. Operation of this equipment in a residential area is likely to cause harmful interference in which case the user will be required to correct the interference at his own expense.

Commercial Downlight with Integral Emergency Battery Backup Installation Instructions



INSTALLATION WITH EXISTING FRAME

1. Shut power OFF to the fixture.
2. Remove CFL, Incandescent or HID lamp. (Fig.1)

Fig: 1

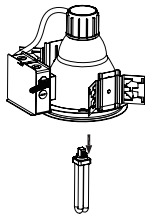

3. Remove reflector from rough-in (mounting frame). (Fig.2)

Fig: 2

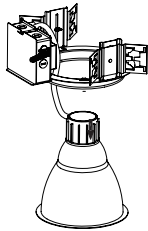

4. Remove socket assembly from reflector. (Fig.3)

Fig: 3

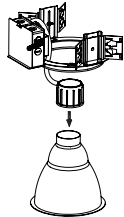

5. Remove J-Box metal plate with existing lamp ballast. Do not dispose. Disconnect all wires from the ballast. (Fig.4)

Fig: 4

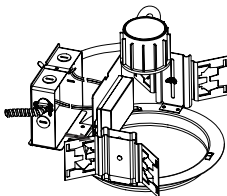

6. Remove the existing lamp metal conduit (MC) cable from the J-Box. (Fig.5)

Fig: 5

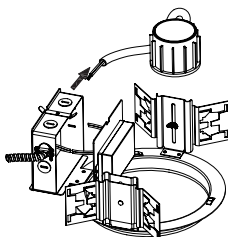

INSTALLATION WITH EXISTING FRAME (cont'd)

7. Connect the MC cable from the emergency battery backup J-Box to the fixture J-Box. Connect wires according to the wiring diagram. Please Note: 4" CDLEM fixtures, SKU# 89218 and 89222 do not contain the Yellow 12V+ wire. (Fig.6)

Fig: 6

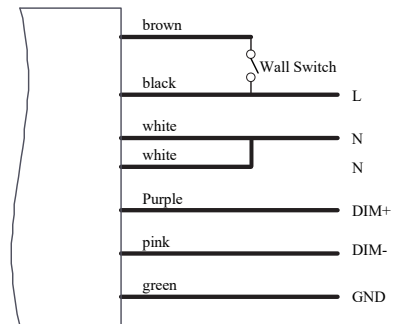
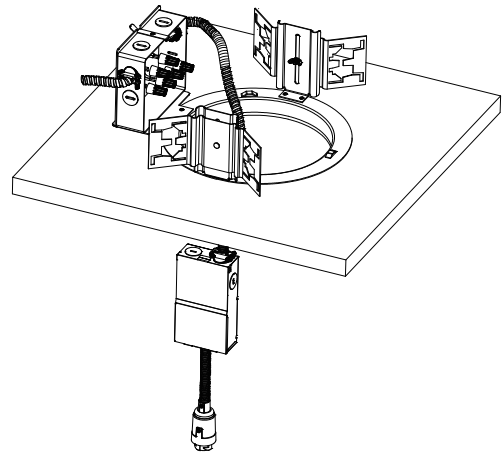

Wiring diagram for 4" CDLEM

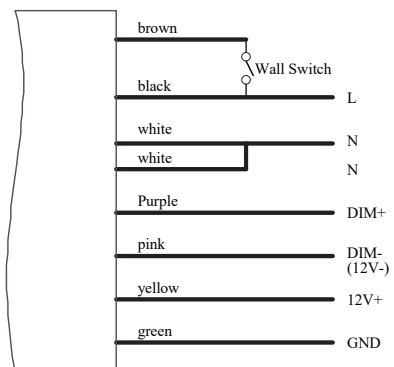

Wiring diagram for 6"/8"/10" CDLEM

Commercial Downlight with Integral Emergency Battery Backup Installation Instructions



INSTALLATION WITH EXISTING FRAME (cont'd)

8. Select desired lumen output and color temperature using switches on the top of the downlight. (Fig.7)

Fig: 7

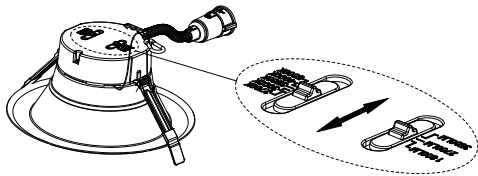

- 9 Attach the safety cable to the fixture frame. Plug the fixture into the Emergency Battery Backup using the quick connect MC cable.(Fig.8)

Fig: 8

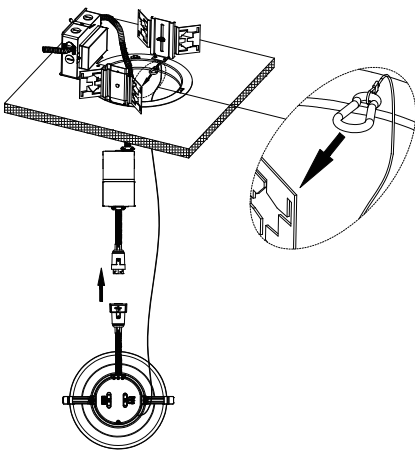

10. Push the Emergency Battery J-Box through the hole and place on the fixture frame. Squeeze the two spring clips so they are in an upright position. (Fig.9)

INSTALLATION WITH EXISTING FRAME (cont'd)

Fig: 9

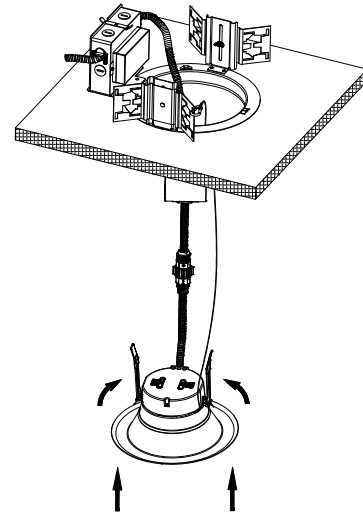

11. Insert the CDLEM into the frame. (Fig.10)

Fig: 10

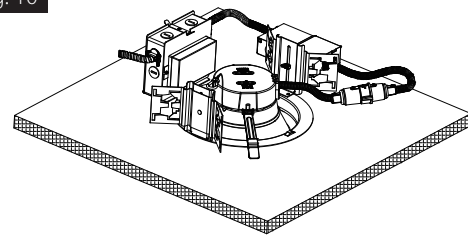

12. Push the fixture until the flange sits flush against the ceiling. (Fig.11)

Fig: 11

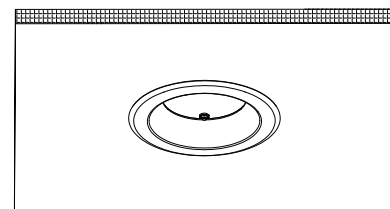

Commercial Downlight with Integral Emergency Battery Backup Installation Instructions



INSTALLATION WITHOUT EXISTING FRAME

1. Use the template included in the box to cut a hole in the ceiling. (Fig.12)

Fig: 12

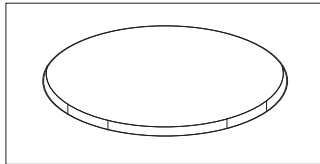

2. Connect the MC cable from the emergency battery backup J-Box to the fixture J-Box. Connect wires according to the wiring diagram. Please Note: 4" CDLEM fixtures, SKU# 89218 and 89222 do not contain the Yellow 12V+ wire. (Fig.13)

Fig: 13

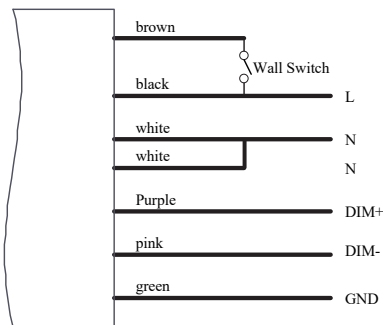
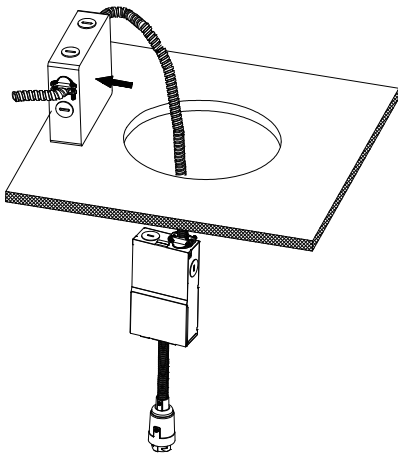

Wiring diagram for 4" CDLEM

INSTALLATION WITHOUT EXISTING FRAME (cont'd)

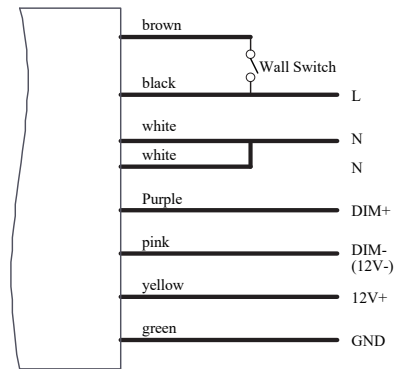

Wiring diagram for 6"/8"/10" CDLEM

3. Select desired lumen output and color temperature using switches on the top of the downlight. (Fig.14)

Fig: 14

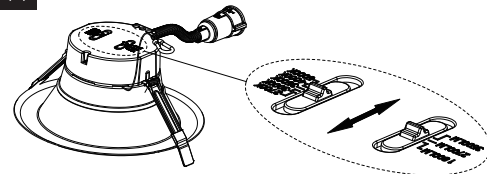

4. Attach the safety cable to the fixture frame. Plug the fixture into the Emergency Battery Backup using the quick connect MC cable. (Fig.15)

Fig: 15

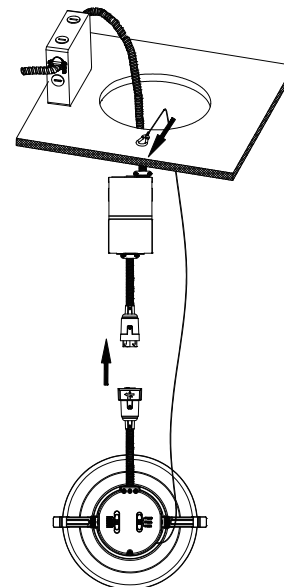

Commercial Downlight with Integral Emergency Battery Backup Installation Instructions



INSTALLATION WITHOUT EXISTING FRAME *(cont'd)*

5. Push the Emergency Battery J-Box through the hole and place on the fixture frame. Squeeze the two spring clips so they are in an upright position. *(Fig.16)*

Fig: 16

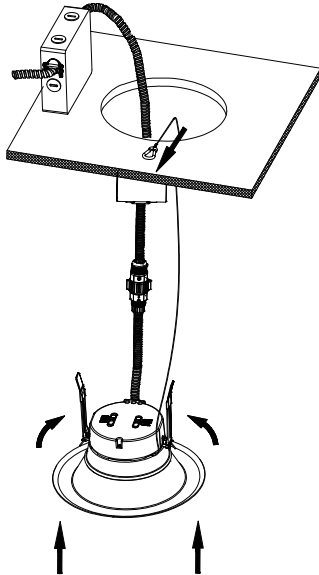

INSTALLATION WITHOUT EXISTING FRAME *(cont'd)*

7. Push the fixture until the flange sits flush against the ceiling. *(Fig.18)*

Fig: 18

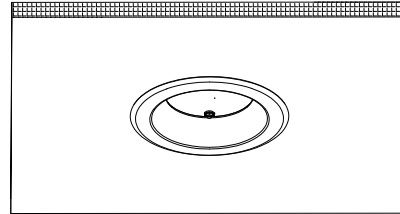

6. Insert the CDLEM into the frame. *(Fig.17)*

Fig: 17

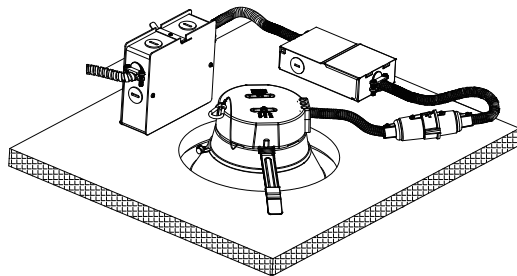



Commercial Downlight with Integral Emergency Battery Backup Installation Instructions



Battery Declaration

- Batteries' lifetime is 5 years. If you are using or stocking the batteries for 5 years, please replace the batteries.
- The batteries cannot be charged for 5000 hours consistently. Batteries need to be discharged once every 5000 hours.

LED indicator status

	Off: Battery disconnected
	Red stable: Battery charging or fully charged

Test switch

The test button is an open switch, if you press it, it connects and then you release it, it cuts off automatically.

When you are doing the daily maintenance, if you press the test button, the emergence driver goes into emergency mode, if you release the button, the emergency driver will go back to normal mode.

LED indicator

The LED indicator light reflects the condition of the battery charger. The RED ring around the test switch will be lit when the battery is charging and will be off in the battery is disconnected.

Note: The LED indicator red light is not conspicuous when the main light is on, cover the main light can see the red indicator.

Attention

- To guarantee the rated discharge time, please charge the battery for more than 12 hours. The battery and fixture operate properly between 80% and 110% of the rated voltage of the luminaire.
- Charge and discharge cycle needs to be done at least once every three months, and the continuous charging time cannot exceed 3 months.

Warranty

- Warranty 5 years
- Except for the following circumstances:
 - 1) Improper installation or operation.
 - 2) Misuse.
 - 3) Abuse.
 - 4) Unauthorized or improper repair alteration.
 - 5) Accident or negligence in use, storage, transportation.
 - 6) Any natural acts.

Monthly

1. Ensure that the test button light is illuminated.
2. Conduct a 30-second discharge test by depressing the test button.
3. The LED load should operate at reduced output.

Annually

1. Allow a 24-hour charge before conducting test.
2. Ensure that the test button light is illuminated.
3. Conduct a full 90-minute discharge test.
4. The unit should operate as intended for the duration of the test.
"Written records of the testing shall be kept by the owner for inspection by the authority having jurisdiction."
SERVICING SHOULD BE PERFORMED BY QUALIFIED PERSONNEL.

Warranty Information:

This product is warranted for 5 years from the date of purchase. If this product does not perform to the specifications supplied on this package, send an email or write to the address below for product return and replacement. This replacement is the sole remedy available. Liability for incidental or consequential damage is expressly excluded. Visit www.halcolighting.com for full warranty details and compatibility information.